

# CERTIFIED CORNER RECORDATION

Corner 1/4 Sec. 22&27 T. 36N R. 27W P.M., MT Lincoln County

- I. 1893 G.L.O. Original Record by Peter McCardell et. al.: Set a limestone, 18X7X6 ins., 12 ins. in the ground for 1/4 sec. cor. mkd. "1/4" on the N. face. Established two bearing trees.

1959-60 B.L.M. Remonumentaton Record by David R. Cunningham et. al.: The 1/4 sec. cor. of secs. 22 and 27, monumented with a limestone, 18x7x6 ins., firmly set, mkd. as described in the original record and witnessed by the remains of the original bearing trees. At the corner position, set an iron post, 30 ins. long, 2 1/2 in. diam., 26 ins. in the ground, in concrete, with the brass cap mkd. as shown:

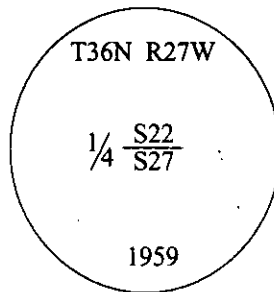

Established two new bearing trees:

A fir, 6 ins. diam., bears N80 1/4°E, 36 lks. dist., mkd. "1/4 S22 BT".

A fir, 6 ins. diam., bears S16 1/2°E, 32 lks. dist., mkd. "1/4 S27 BT".

Bury the original stone alongside and raise a mound of stone, 3.0 ft. base, 2.0 ft. high, N. of the iron post.

1975 Certified Corner Recordation by Jack Ninneman Registration No. 534 ES: Found a BLM brass cap, witnessed by two bearing trees and one stump.

- II. Found a 3 1/4 in. diam. BLM brass cap, firmly set, protruding 2 ins. above the ground, mkd. as shown above. A mound of stone, 3.0 ft. diam., West, 1.0 ft. dist. from the corner.

from which:

A fir, 8 ins. diam., bears N80°E, 23.8 ft. dist., with a healed face.. (BLM-record)

A fir, 12 ins. diam., bears S16°E, 21.1 ft. dist., with a healed face. (BLM-record)

A rotten stump, bears S28°E, 9.2 ft. dist., with visible scribe. (GLO-record)

A stump, 22 ins. diam., bears N05°W, 62.7 ft. dist., with axe marks. (GLO-record)

- III. Set a 6 ft. steel post, North, on property line, 3.0 ft. dist. from the corner, with Land Survey Monument and Property Boundary decals attached.  
Painted bearing trees and attached Land Survey Monument and Bearing Tree signs.  
K-tag located, East, on road No. 3668.

Magnetic Declination: 20° East.

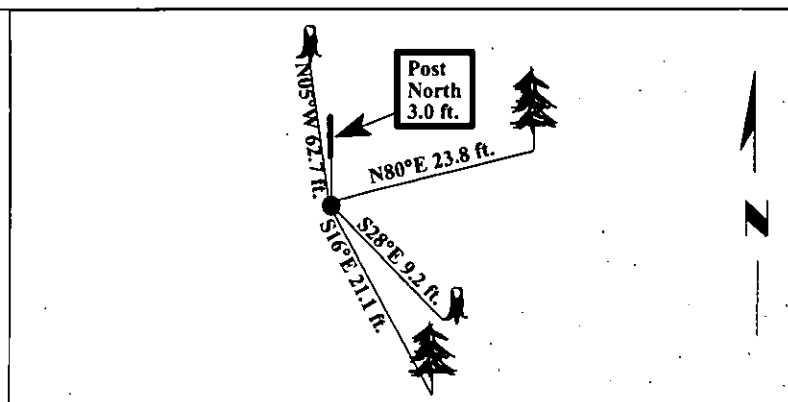

SKETCH OF CORNER

CERTIFICATION

I, Mark Federman  
certify the information shown herein is true and correct.

I, Ronald A. Pearson  
certify that this Corner Record correctly represents work performed by me or under my direction in compliance with the "Corner Recordation Act" (70-22-101, et seq., M.C.A.)

Signature of Surveyor & Seal

Date: 05/05/97

Reg. No.: 9008LS

Employer: U.S. FOREST SERVICE

Office of Clerk and Recorder, County of LINCOLN. This "corner record" was filed for record on JULY 31, 1997 was noted on the cross-index plat and is assigned page No. 9849 in book No. \_\_\_\_\_

CORAL M. CUMMINGS

County Official

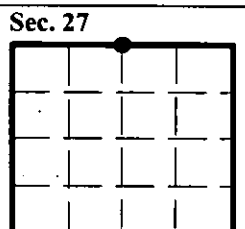

• - corner this sheet