

CERTIFIED CORNER RECORDATION

Corner 1/4 Sec. 26&27 T. 36N R. 27W P.M., MT Lincoln County

I. 1893 G.L.O. Original Record by Peter McCardell et. al.: Set a limestone, 20X8X6 ins., 15 ins. in the ground for 1/4 sec. cor. mkd. "1/4" on the W. face. Established two bearing trees.

1959-60 B.L.M. Remonumentaton Record by David R. Cunningham et. al.: The 1/4 sec. cor. of secs. 26 and 27, monumented with a limestone, 12x6x4 ins., firmly set, mkd. as described in the original record and witnessed by the remains of the original bearing trees. At the corner position, set an iron post, 30 ins. long, 2 1/2 in. diam., 28 ins. in the ground, in concrete, with the brass cap mkd. as shown:

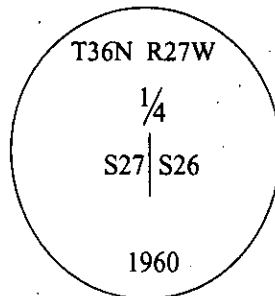

Established two new bearing trees:

A fir, 9 ins. diam., bears S53 1/2°E, 99 lks. dist., mkd. "1/4 S26 BT".

A fir, 11 ins. diam., bears N34°W, 68 lks. dist., mkd. "1/4 S27 BT".

Bury the original stone alongside and raise a mound of stone, 3.0 ft. base, 2.0 ft. high, W. of the iron post.

II. Found a 3 1/4 in. diam. BLM brass cap, firmly set, protruding 1 in. above the ground, and mkd. as shown above. A mound of stone, 3.0 ft. diam., West from the corner.

from which:

A fir, 20 ins. diam., bears S53°E, 65.3 ft. dist., with a healed face.. (BLM-record)

A stump, 13 ins. diam., bears S56°E, 26.4 ft. dist., no visible scribe. (GLO-record)

A fir, 20 ins. diam., bears N34°W, 44.9 ft. dist., with a healed face. (BLM-record)

A rotten stump, bears N65°W, 71.3 ft. dist., no visible scribe. (GLO-record)

III. Painted bearing trees and attached Land Survey Monument and Bearing Tree signs. K-tag located, South, on road No. 3668, 600 ft. dist. from the corner.

Magnetic Declination: 20° East.

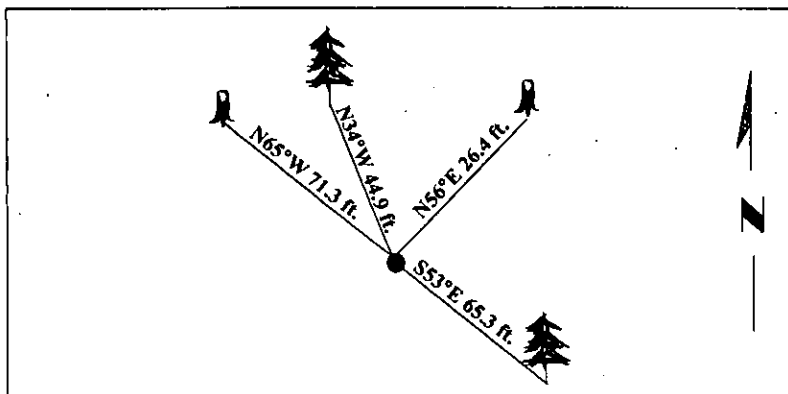

SKETCH OF CORNER

I. Mark Federman

CERTIFICATION certify the information shown herein is true and correct.

I. Ronald A. Pearson

certify that this Corner Record correctly represents work performed by me or under my direction in compliance with the Corner Recordation Act (70-22-101, et seq., M.C.A.)

Signature of Surveyor & Seal

Date: 05/05/97

Reg. No.: 9008LS

Employer: U.S. FOREST SERVICE

Sec. 26

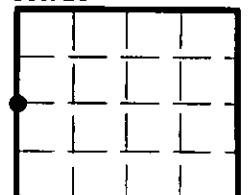

• - corner this sheet

Office of Clerk and Recorder, County of LINCOLN. This "corner record" was filed for record on JULY 31, 1997 was noted on the cross-index plat and is assigned page No. 9848 in book No. CORAL M. CUMMINGS By RUB

County Official

Cross Index No. T-17 T. 36N R. 27W P.M., MT