

CERTIFIED CORNER RECORDATION

Corner 1/4 Sec. 23&26 T. 36N R. 27W P.M., MT Lincoln County

I. 1893 G.L.O. Original Record by Peter McCardell et. al.: Set a limestone, 22X10X8 ins., 17 ins. in the ground for 1/4 sec. cor. mkd. "1/4" on the N. face. Established two bearing trees.

1959-60 B.L.M. Remonumentaton Record by David R. Cunningham et. al.: The 1/4 sec. cor. of secs. 23 and 26, monumented with a limestone, 18x10x10 ins., firmly set, mkd. as described in the original record and witnessed by the remains of the original bearing trees. At the corner position, set an iron post, 30 ins. long, 2 1/2 in. diam., 28 ins. in the ground, in concrete, with the brass cap mkd. as shown:

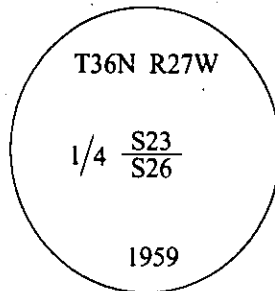

Established two new bearing trees:

A fir, 5 ins. diam., bears S32 1/2°E, 44 lks. dist., mkd. "1/4 S26 BT".

A fir, 8 ins. diam., bears N85 3/4°W, 26 lks. dist., mkd. "1/4 S23 BT".

Bury the original stone alongside and raise a mound of stone, 2 1/2 ft. base, 1 1/2 ft. high, N. of the iron post.

II. Found a 3 1/2 in. diam. brass cap, firmly set, flush with the ground, and mkd. as shown above. A mound of stone, 1.5 ft. high, North, 2.0 ft. dist. from the corner.

from which:

A rotten stump, bears N44°E, 4.6 ft. dist., no visible marks. (GLO-record)

A rotten stump, bears S60°E, 6.6 ft. dist., no visible marks. (GLO-record)

A fir, 12 ins. diam., bears S73°E, 29.0 ft. dist., with a healed face. (BLM-record-S32 1/2°E)

A fir, 14 ins. diam., bears N28°W, 17.2 ft. dist., with a healed face. (BLM-record-N85 1/4°W)

III. Painted bearing trees and attached Land Survey Monument and Bearing Tree signs.

Magnetic Declination: 20° East.

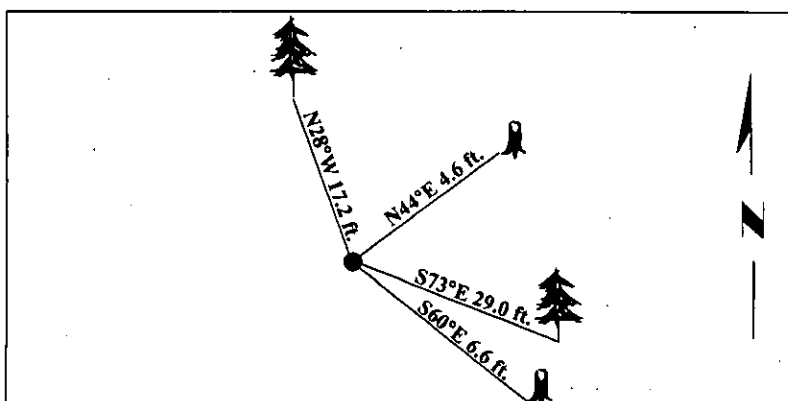

SKETCH OF CORNER

CERTIFICATION

I. Mark Federman
certify the information shown herein is true and correct.

I. Ronald A. Pearson
certify that this Corner Record correctly represents work performed by me or under my direction in compliance with the "Corner Recordation Act" (70-22-101, et seq., M.C.A.)

Signature of Surveyor & Seal

Date: 05/05/97

Reg. No.: 9008LS

Employer: U.S. FOREST SERVICE

Office of Clerk and Recorder, County of LINCOLN. This "corner record" was filed for record on JULY 31, 1997 was noted on the cross-index plat and is assigned page No. 9846 in book No. CORAL M. CUMMINGS

County Official By DeB

Sec. 26

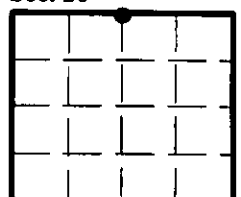

• - corner this sheet