

CERTIFIED CORNER RECORDATION

Corner CE 1/16 Sec. 27 T. 36N R. 27W P.M., MT Lincoln County

- I. No history found.
- II. No evidence found.
- III. Set by survey, an aluminum rod, 30 ins. long, 3/4 in. diam., 8 ins. below the road surface, with a 3 1/4 in. diam. aluminum cap mkd. as shown below:

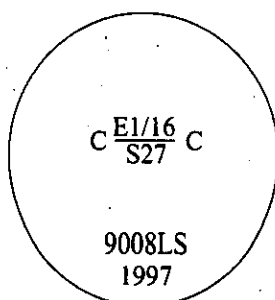

Established two bearing trees:

- A larch, 11 ins. diam., bears N09°E, 44.6 ft. dist., mkd. "CE 1/16 S27 BT".
- A fir, 12 ins. diam., bears N74°E, 74.2 ft. dist., mkd. "CE 1/16 S27 BT".

Painted bearing trees and attached Land Survey Monument and Bearing Tree signs.
Corner falls in the middle of road no. 3668.

Magnetic Declination: 20° East.

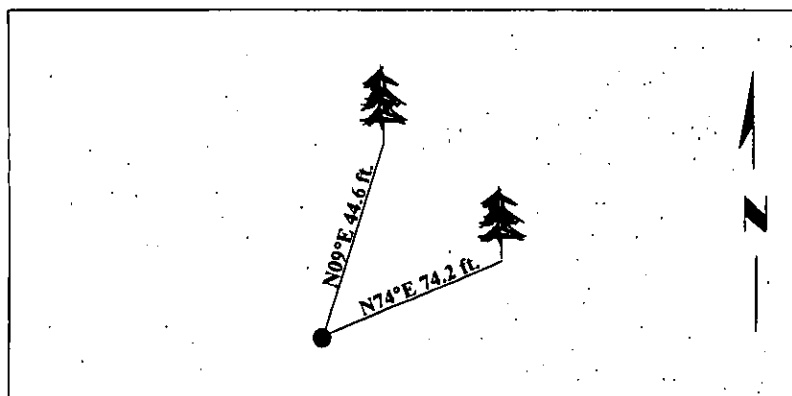

SKETCH OF CORNER

CERTIFICATION

I, Rex O. Rice
certify the information shown herein is true and correct.

I, Ronald A. Pearson
certify that this Corner Record correctly represents work performed by me or under my direction in compliance with the "Corner Recordation Act" (70-22-101, et seq., M.C.A.)

[Signature]
Signature of Surveyor & Seal

Date: 06/03/97

Reg. No.: 9008LS

Employer: U.S. FOREST SERVICE

Office of Clerk and Recorder, County of LINCOLN. This "corner record" was filed for record on JULY 31, 1997 was noted on the cross-index plat and is assigned page No. 9844 in book No. CORAL M. CUMMINGS By [Signature] County Official

