

CERTIFIED CORNER RECORDATION

Corner 1/4 Sec. 31&36 T. 36N R. 26W P.M., MT Lincoln County
27W

- I. 1893 G.L.O. Original Record by Peter McCardell et. al.: Set a sandstone, 14X10X8 ins., 10 ins. in the ground for 1/4 sec. cor. mkd. "1/4" on the W. face.

Established two bearing trees:

- A fir, 12 ins. diam., bears S80°E, 25 lks. dist., mkd. "1/4 S BT".
A fir, 10 ins. diam., bears S15°W, 10 lks. dist., mkd. "1/4 S BT".

1959-60 B.L.M. Remonumentation Record by David R. Cunningham: The 1/4 sec. cor. of secs. 31 and 36, on the West boundary of the Township, monumented with a sandstone, 14x12x8 ins., firmly set, and mkd. "1/4" on the W. face, and witnessed by the original bearing trees. At the corner point, set an iron post, 30 ins. long, 2 1/2 in. diam., 26 ins. in the ground, in concrete, with brass cap mkd. as shown:

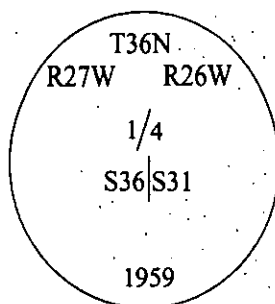

Established two new bearing trees:

- A fir, 7 ins. diam., bears S52 3/4°E, 47 lks. dist., mkd. "1/4 S31 BT".
A fir, 8 ins. diam., bears N43 1/2°W, 57 lks. dist., mkd. "1/4 S36 BT".

Bury the original stone alongside and raise a mound of stone, 2 ft. base, 1 1/2 ft. high, W. of the iron post.

- II. Found a 2 1/2 in. diam. iron pipe, firmly set, protruding 3 ins. above the ground, with a 3 1/4 in. diam. brass cap mkd. as shown above. A mound of stone, West, 2.0 ft. dist. from the corner.

from which:

- A fir, 19 ins. diam., bears S17°W, 7.0 ft. dist., with visible scribe. (GLO-record)
A fir, 10 ins. diam., bears S53°E, 31.5 ft. dist., with a healed face. (BLM-record)
A dead fir, 16 ins. diam., bears S83°E, 16.8 ft. dist., with a chopped face. (GLO-record)
A fir, 15 ins. diam., bears N35°W, 37.6 ft. dist., with a healed face. (BLM-record)

- III. Painted bearing trees and attached Land Survey Monument and Bearing Tree signs.

Magnetic Declination: 20° East.

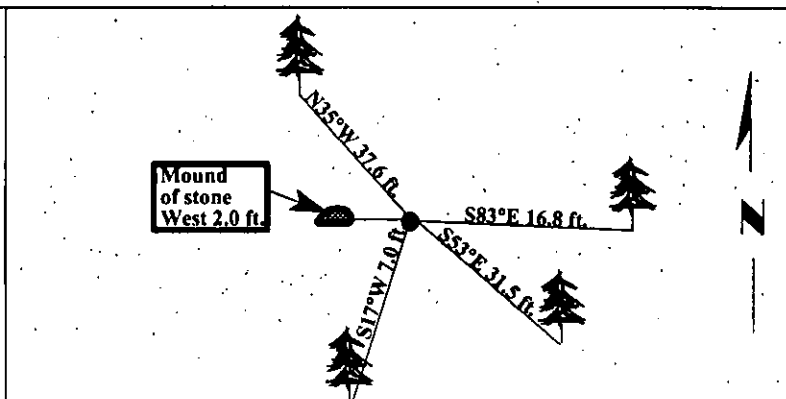

SKETCH OF CORNER

CERTIFICATION

I. Rex O. Rice
certify the information shown herein is true and correct.

I. Ronald A. Pearson
certify that this Corner Record correctly represents work performed by me or under my direction in compliance with the "Corner Recordation Act" (70-22-101, et seq., M.C.A.)

Signature of Surveyor & Seal

Date: 06/11/97

Reg. No.: 9008LS

Employer: U.S. FOREST SERVICE

Sec. 36

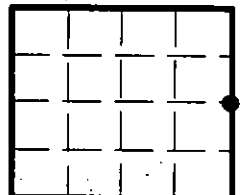

Office of Clerk and Recorder, County of LINCOLN. This "corner record" was filed for record on JULY 31, 1997 was noted on the cross-index plat and is assigned page No. 9840 in book No. CORAL M. CUMMINGS By DLB

County Official

• - corner this sheet

Cross Index No. X-25 T. 36N R. 26W- P.M., MT
27W