

CERTIFIED CORNER RECORDATION

Corner 1/4 Sec. 24&25 T. 36N R. 27W P.M., MT Lincoln County

I. 1893 G.L.O. Original Record by Peter McCardell et. al.: Set a post, 3 ft. long, 3 ins. square, 24 ins. in the ground, for 1/4 sec. cor. mkd. "1/4 S" on the N. face. Established two bearing trees.

1975 Certified Corner Recordation by D.K. Marquardt No. ES 2989: No record found of the original post and bearing trees. Set by single proportion, a brass cap, mkd. as shown. Established two bearing trees.

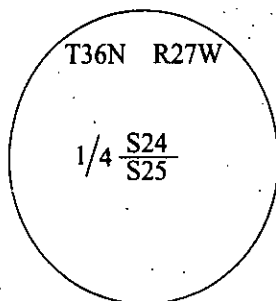

II. Found a 2 in. diam. iron pipe, firmly set, flush with the ground, no cap attached to pipe.

from which:

A cottonwood, 55 ins. diam., bears N24°E, 41.3 ft. dist., no visible marks. (1975-record-N20°E-39.50 ft.)

III. Accepted position of the found pipe, as per Cerified Corner Recordation by ES 2989, set an aluminum pipe, 30 ins. long, 2 1/2 in. diam., with found pipe inside, 23 ins. in the ground, with a 3 1/4 in. diam. aluminum cap mkd. as shown below.

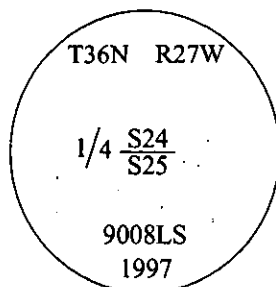

No other bearing trees available, within limits, as corner falls in a field.

Put a location poster on a railroad tie-fence post, North, 1.0 ft. dist. from monument, to side center.

Painted bearing trees and attached Land Survey Monument and Bearing Tree signs.

Magnetic Declination: 20° East.

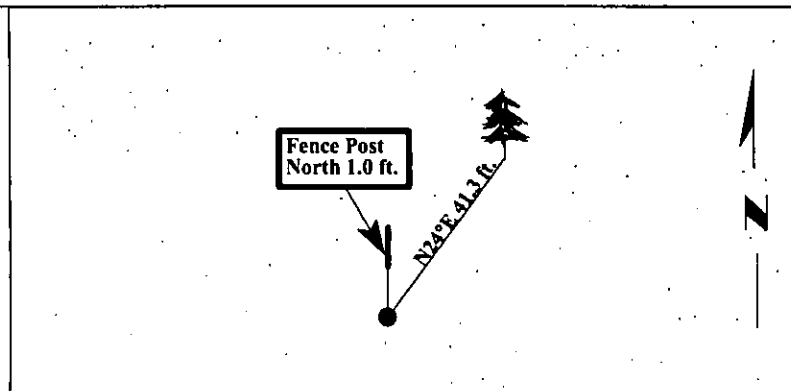

SKETCH OF CORNER

I. Rex O. Rice

certify the information shown herein is true and correct

I. Ronald A. Pearson

certify that this Corner Record correctly represents work performed by me or under my direction in compliance with the "Corner Recordation Act" (70-22-101, et seq., M.C.A.)

Signature of Surveyor & Seal

Date: 06/11/97

Reg. No.: 9008LS

Employer: U.S. FOREST SERVICE

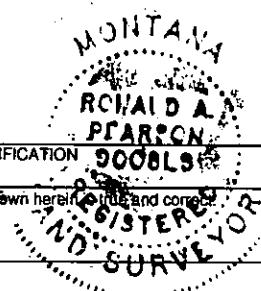

Office of Clerk and Recorder, County of LINCOLN. This "corner record" was filed for record on JULY 31, 1997 was noted on the cross-index plat and is assigned page No. 9839 in book No. CORAL M. CUMMINGS By DLB

County Official

Sec. 25

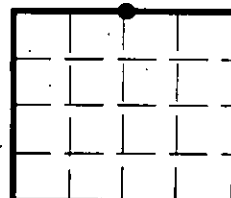

• - corner this sheet

Cross Index No. R-23 T. 36N R. 27W P.M., MT