

CERTIFIED CORNER RECORDATION

Corner 1/4 Sec. 36 only T. 36N R. 27W P.M., MT Lincoln County

I. 1893 G.L.O. Original Record by Peter McCardell et. al.: Set a limestone, 12X10X7 ins., 8 ins. in the ground for 1/4 sec. cor. of 1 and 36, mkd. "1/4" on the N. face. Established two bearing trees.

1917 H.E.S. No. 781 & 782 record by R.E. Maurer: Corner No. 5 of H.E.S. 781 is identical in point for list corner No. 2 of H.E.S. 782. Both corners being identical with the 1/4 sec. cor. on S. boundary of sec. 36, which is a limestone, 6x8x6 ins., above ground, heretofore described. Mark this stone for cor. No. 5 with a cross (X) on top for the exact corner point. Establish two bearing trees and raise a mound of earth, 4.0 ft. base, 2.0 ft. high, S.E. of the corner. Set a stake alongside, mkd. "5 H.E.S. 781" on the S.E. face.

1959-60 B.L.M. Remonumentation Record by David R. Cunningham: The 1/4 sec. cor. of secs. 36, on the S. boundary of the Tp., identical with cor. No. 2 of H.E.S. No. 782 and cor. No. 5 of H.E.S. No. 781, monumented with a limestone, 10x7x6 ins. firmly set, mkd. "1/4" on the N. face, and witnessed by the remains of the H.E.S. bearing trees. At the corner point, set an iron post, 30 ins. long, 2 1/2 in. diam., 26 ins. in the ground, in concrete, with the brass cap mkd. as shown:

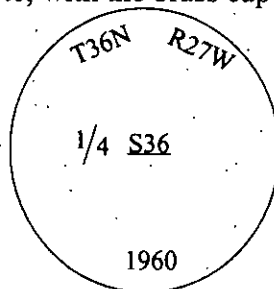

Established one new bearing tree:

A fir, 9 ins. diam., bears N40 3/4°E, 91 lks. dist., mkd. "1/4 S36 BT".
Bury the original stone alongside of the iron post.

II. Found a 2 1/2 in. diam. aluminum pipe, firmly set, protruding 2 ins. above the ground, with a 3 1/4 in. diam. B.L.M. brass cap mkd. as shown above.

from which:

A fir, 15 ins. diam., bears N40°E, 59.6 ft. dist., with a healed face. (BLM-record)
A stump, 25 ins. diam., bears S43°E, 39.6 ft. dist., with visible scribe. (1917-record-S41°18'E)
A fir, 26 ins. diam., bears N88°W, 9.0 ft. dist., with visible scribe. (1917-record-S87°48'W)

III. Set a 6 ft. steel post, East, on property line, 3.0 ft. dist. from the corner, with Land Survey Monument and Property Boundary decals attached.
Painted bearing trees and attached Land Survey Monument and Bearing Tree signs.

Magnetic Declination: 20° East.

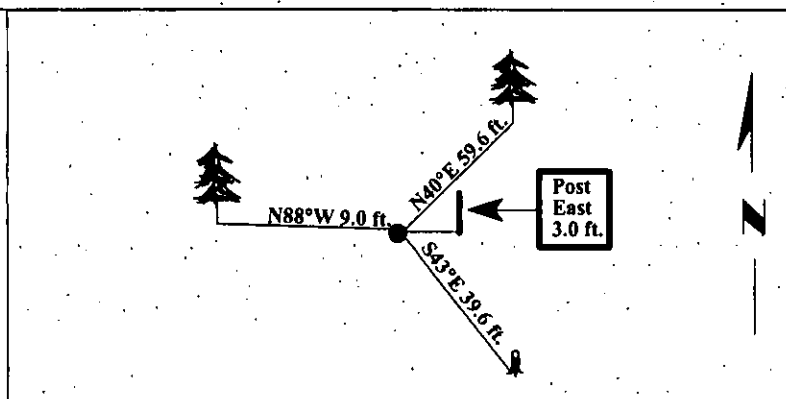

SKETCH OF CORNER

<p>CERTIFICATION</p> <p>I, <u>Rex O. Rice</u></p> <p>certify the information shown herein is true and correct.</p>	
<p>I, <u>Ronald A. Pearson</u></p> <p>certify that this Corner Record correctly represents work performed by me or under my direction in compliance with the "Corner Recordation Act" (70-22-101, et seq., M.C.A.)</p> <p><u>[Signature]</u></p> <p>Signature of Surveyor & Seal</p>	
<p>Date: <u>06/10/97</u></p>	
<p>Reg. No.: <u>9008LS</u></p>	
<p>Employer: <u>U.S. FOREST SERVICE</u></p>	

Office of Clerk and Recorder, County of LINCOLN. This "corner record" was filed for record on JULY 31, 1997 was noted on the cross-index plat and is assigned page No. 9838 in book No. CORAL M. CUMMINGS By RLB

County Official

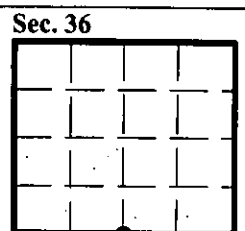

• - corner this sheet

Cross Index No. Z-23 T. 36N R. 27W P.M., MT