

CERTIFIED CORNER RECORDATION

Corner N.E. Sec. 36 T. 36 N R. 26W- P.M., MT Lincoln County
Cor. 27W

I. 1893 G.L.O. Original Record by Peter McCardell et. al.: Set a sandstone, 18x12x8 ins., 12 ins. in the ground, for cor. to secs. 25,30,31&36 mkd. with 1 notch on S. and 5 notches on the N. edges. from which:

- A larch, 15 ins. diam., bears N35°E, 22 lks. dist., mkd. "T36N R26W S30 BT".
- A larch, 12 ins. diam., bears S73°30E, 34 lks. dist., mkd. "T36N R26W S31 BT".
- A larch, 11 ins. diam., bears S69°30W, 54 lks. dist., mkd. "T36N R27W S36 BT".
- A pine, 16 ins. diam., bears N38°W, 53 lks. dist., mkd. "T36N R27W S25 BT".

1959-60 B.L.M. Remonumentation Record by David R. Cunningham et. al.: The cor. of secs.25,30,31&36, monumented with a sandstone, 18x12x8 ins., firmly set, mkd. as described in the original record, and witnessed by the remains of two of the original bearing trees. At the corner point, set an iron post, 30 ins. long, 2 1/2 in. diam., 27 ins. the ground, in concrete, with brass cap mkd. as shown:

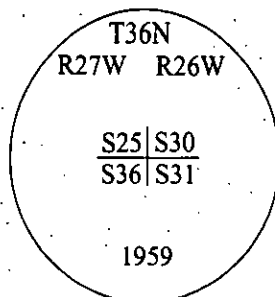

Established four new bearing trees:

- A larch, 10 ins. diam., bears N77 1/4°E, 21 lks. dist., mkd. "T36N R26W S30 BT".
- A fir, 11 ins. diam., bears S42 1/2°E, 89 lks. dist., mkd. "T36N R27W S31 BT".
- A larch, 13 ins. diam., bears S39°W, 99 lks. dist., mkd. "T36N R27W S36 BT".
- A larch, 5 ins. diam., bears N18 1/4°W, 37 lks. dist., mkd. "T36NR27W S25 BT".

Bury the original stone alongside and raise a mound of stone, 3 ft. base, 2 ft. high, W. of the iron post.

II. Found a 2 1/2 in. diam. iron pipe, firmly set, protruding 7 ins. above the ground, with a 3 1/4 in. diam. B.L.M brass cap mkd. as shown above. from which:

- A larch, 17 ins. diam., bears N77°E, 13.86 ft. dist., with a healed face. (BLM-record)
- A fir, 14 ins. diam., bears S42°E, 58.7 ft. dist., with visible scribe. (BLM-record)
- A larch, 17 ins. diam., bears S39°W, 66.0 ft. dist., with a healed face. (BLM-record)
- A larch, 9 ins. diam., bears N18°W, 24.4 ft. dist., with a healed face. (BLM-record)

III. Set a 6 ft. steel post, North, on property line, 3.0 ft. dist. from the corner, with Land Survey Monument and Property Boundary decals attached. Painted bearing trees and attached Land Survey Monument and Bearing Tree signs.

Magnetic Declination: 20° East.

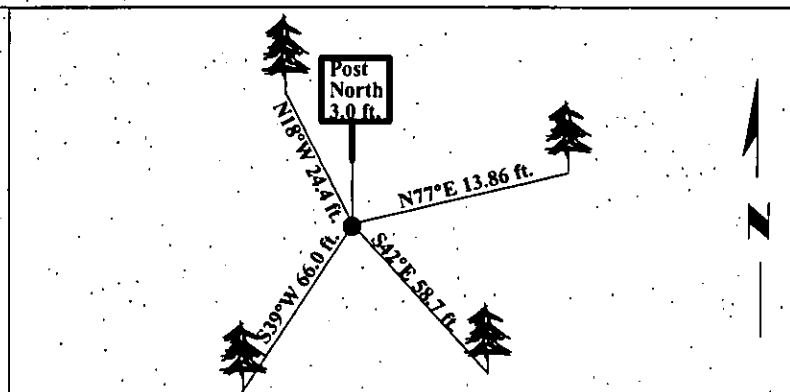

SKETCH OF CORNER

CERTIFICATION

I, Rex O. Rice
certify the information shown herein is true and correct.

I, Ronald A. Pearson
certify that this Corner Record correctly represents work performed by me or under my direction in compliance with the "Corner Recordation Act" (70-22-101, et seq., M.C.A.)

Signature of Surveyor & Seal

Date: 06/10/97

Reg. No.: 9008LS

Employer: U.S. FOREST SERVICE

Office of Clerk and Recorder, County of LINCOLN. This "corner record" was filed for record on JULY 31, 1997 was noted on the cross-index plat and is assigned page No. 9834 in book No. CORAL M. CUMMINGS By JLB

County Official

Sec. 36

• corner this sheet

Cross Index No. V-25 T. 36N R. 27W P.M., MT