

# CERTIFIED CORNER RECORDATION

Corner CN 1/16 Sec. 27 T. 36N R. 27W P.M., MT Lincoln County

- I. No history found.
- II. No evidence found.
- III. Set by survey, an aluminum rod, 30 ins. long, 3/4 in. diam., 27 ins. in the ground, with a 3 1/4 in. diam. aluminum cap mkd. as shown:

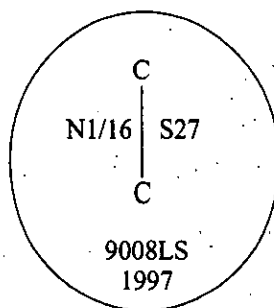

Established two bearing trees and two posts:

- A fir, 14 ins. diam., bears N10°E, 52.1 ft. dist., mkd. "CN 1/16 S27 BT".
- A fir, 8 ins. diam., bears N82°E, 30.3 ft. dist., mkd. "X" on snowblaze "BT".
- A 6 ft. steel guard post, North, on property line, 3.0 ft. dist. from the corner.
- A 6 ft. steel guard post, East, on property line, 3.0 ft. dist. from the corner.

Painted bearing trees and attached Land Survey Monument and Bearing Tree signs.  
Attached Land Survey Monument and Property Boundary decals to the posts.

Magnetic Declination: 20° East.

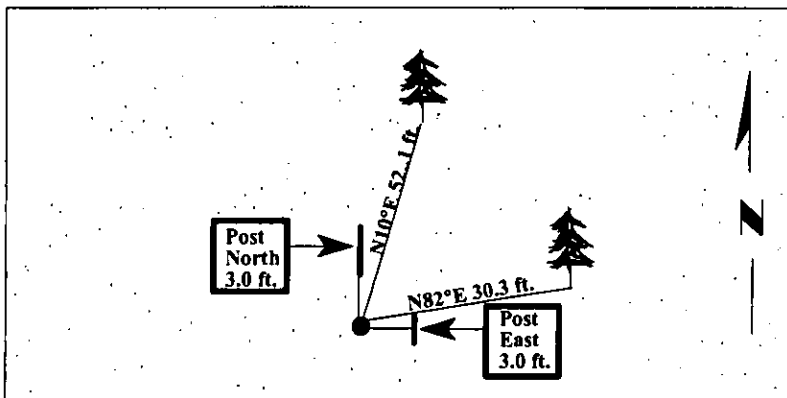

SKETCH OF CORNER

CERTIFICATION

I. Rex O. Rice  
certify the information shown herein is true and correct.

I. Ronald A. Pearson  
certify that this Corner Record correctly represents work performed by me or under my direction in compliance with the "Corner Recordation Act" (74-22-101, et seq., M.C.A.)

Ronald A. Pearson  
Signature of Surveyor & Seal

Date: 06/03/97

Reg. No.: 9008LS

Employer: U.S. FOREST SERVICE

Office of Clerk and Recorder, County of LINCOLN. This "corner record" was filed for record on JULY 31, 1997 was noted on the cross-index plat and is assigned page No. 9831 in book No. CORAL M. CUMMINGS By RUB

County Official

Sec. 27

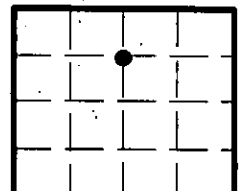

• - corner this sheet