

CERTIFIED CORNER RECORDATION

Corner N 1/16 Sec. 25&26 T. 36N R. 27W P.M., MT Lincoln County

- I. 1993 Certificate of Survey No. 2028 by Dawn Marquardt Registration No. 7328 S: Set a 5/8 in. x 24 in. rebar with a plastic cap, stamped "7328 S".
- II. Found a 5/8 in. diam. rebar, firmly set, protruding 2 ins. above the ground, with a yellow plastic cap, stamped "Marquardt 2989 ES". No bearing trees found. Certificate of Survey No. 2028, shows set rebar, with plastic cap stamped "7328 S".
- III. Accepted the found position of the Marquardt rebar and set a 3/4 in. diam. x 30 ins. long aluminum rod, at the found rebar position, 27 ins. in the ground, with a 3 1/4 in. diam. aluminum cap, mkd. as shown:

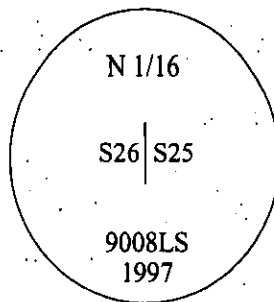

from which:

- A fir, 8 ins. diam., bears N52°E, 30.9 ft. dist., mkd. "N 1/16 S25 BT".
- A fir, 5 ins. diam., bears N55°W, 22.5 ft. dist., mkd. "N 1/16 S26 BT".
- A 6 ft. steel post, bears South, on property line, 3.0 ft. dist. from the corner.

Painted bearing trees and attached Land Survey Monument and Bearing Tree signs.
Attached Land Survey Monument and Property Boundary decals to the post.

A location poster, bears N45°E, approx. 125 ft. dist. from the corner, located near the beginning of the Frank Lake Road.

Magnetic Declination: 20° East.

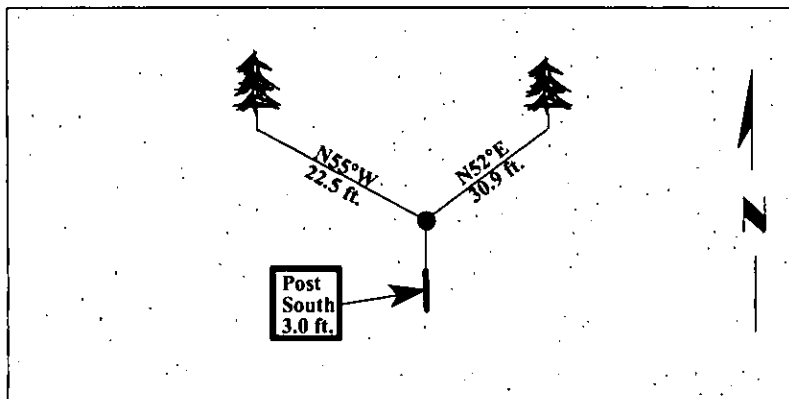

SKETCH OF CORNER

CERTIFICATION

I, Mark Federman certify the information shown herein is true and correct.

I, Ronald A. Pearson certify that this Corner Record correctly represents work performed by me or under my direction in compliance with the Corner Recordation Act (70-22-101, et seq., M.C.A.)

[Signature]
Signature of Surveyor & Seal

Date: 05/01/97

Reg. No.: 9008LS

Employer: U.S. FOREST SERVICE

Office of Clerk and Recorder, County of LINCOLN. This "corner record" was filed for record on JULY 31, 1997 was noted on the cross-index plat and is assigned page No. 9826 in book No. _____

GORAL M. CUMMINGS
County Official

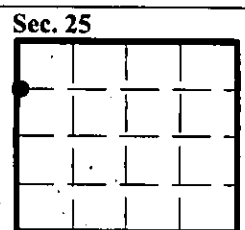

• corner this sheet