

CERTIFIED CORNER RECORDATION

Corner N.W. Sec. 25 T. 36 N R. 27 W P.M., MT Lincoln County
Cor.

- I. 1893 G.L.O. Original Record by Peter McCardell et. al.: Set a limestone, 16x10x5 ins., 11 ins. in the ground, for cor. to secs. 23,24,25&26 mkd. with 2 notches on S. and 1 notch on E. edges. Set four bearing trees.
1959-60 B.L.M. Remonumentation Record by David R. Cunningham et. al.: The cor. of secs.23,24,25&26, monumented with a limestone, 18x12x6 ins., firmly set, and mkd. with 1 groove on E. and 2 grooves on S. faces, and witnessed by the remains of three original bearing trees. At the corner point, set an iron post, 30 ins. long, 2 1/2 in. diam., 26 ins. the ground, in concrete, with brass cap mkd. as shown:

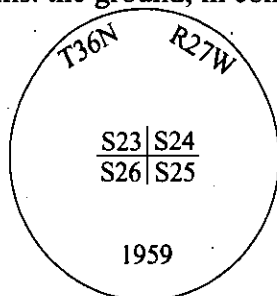

Established four new bearing trees:

- A larch, 9 ins. diam., bears N26 1/2°E, 79 lks. dist., mkd. "T36N R27W S24 BT".
- A larch, 7 ins. diam., bears S71 3/4°E, 88 lks. dist., mkd. "T36N R27W S25 BT".
- A larch, 8 ins. diam., bears S46 3/4°W, 96 lks. dist., mkd. "T36N R27W S26 BT".
- A fir, 7 ins. diam., bears N21°W, 41 lks. dist., mkd. "T36NR27W S23 BT".

Bury the original stone alongside and raise a mound of stone, 3 ft. base, 2 ft. high, W. of the iron post.
1981 Certified Corner Recordation by D.K. Marquardt 2989 ES: Found a B.L.M. brass cap, and witnessed by four bearing trees.

- II. Found a 2 1/2 in. diam. iron pipe, firmly set, protruding 2 ins. above the ground, with a 3 1/4 in. diam. B.L.M brass cap mkd. as shown above. A 2.0 ft. diam. rock pile, West, 1.0 ft. dist. from the corner. from which:

- A stump, 19 ins. diam., bears N17°E, 29.7 ft. dist., chopped face w/ possible scribe. (GLO-rec.)
- A stump, 12 ins. diam., bears N27°E, 52.1 ft. dist., no visible marks. (BLM-record)
- A larch, 11 ins. diam., bears S71°E, 58.7 ft. dist., with a healed face. (BLM-record)
- A 6' larch snag, 9 ins. diam., bears S47°W, 63.0 ft. dist., with visible scribe. (BLM-record)
- A fir stump, bears N21°W, 27.1 ft. dist., with visible scribe. (BLM-record)
- The remains of a root crown, bears N44°W, 5.9 ft. dist. (GLO-record)

- III. Established three new bearing trees:

- A fir, 12 ins. diam., bears N13°E, 25.1 ft. dist., mkd. "T36N R27W S24W BT".
- A fir, 16 ins. diam., bears S61°W, 79.4 ft. dist., mkd. "T36N R27W S26W BT".
- A fir, 6 ins. diam., bears N67°W, 68.7 ft. dist., mkd. "T36N R27W S23W BT".

Set a 6 ft. steel post, East, on property line, 3.0 ft. dist. from the corner, with Land Survey Monument and Property Boundary decals. Painted bearing trees and attached Land Survey Monument and Bearing Tree signs.

Magnetic Declination: 20° East.

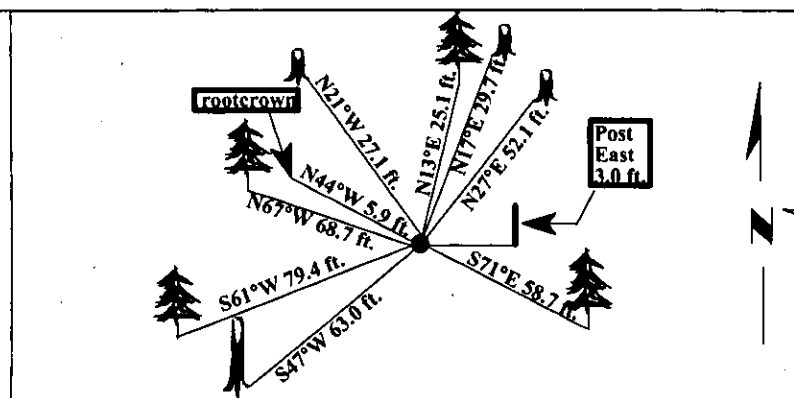

SKETCH OF CORNER

CERTIFICATION	
I. Mark Federman	certify the information shown herein is true and correct
II. Ronald A. Pearson	
certify that this Corner Record correctly represents work performed by me or under my direction in compliance with the "Corner Recordation Act" (70-22-101, et seq., M.C.A.)	
Signature of Surveyor & Seal	
Date:	04/29/97
Reg. No.:	9008LS
Employer:	U.S. FOREST SERVICE

Office of Clerk and Recorder, County of LINCOLN. This "corner record" was filed for record on JULY 31, 1997 was noted on the cross-index plat and is assigned page No. 9825 in book No. CORAL M. CUMMINGS By RUB

County Official

Cross Index No. R-21

T. 36N R. 27W P.M., MT

Adopted July 1, 1981, Montana Board of Professional Engineers & Land Surveyors

Sec. 25

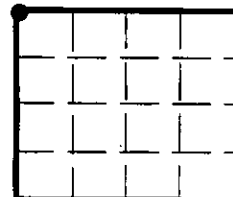

• - corner this sheet