

# CERTIFIED CORNER RECORDATION

Corner N.W. Sec. Sec. 36 T. 36 N R. 27 W P.M., MT Lincoln County  
Cor.

- I. 1893 G.L.O. Original Record by Peter McCardell et. al.: Set a limestone, 14x12x8 ins., 10 ins. in the ground, for cor. to secs. 25,26,35&36 mkd. with 1 notch on S. and the E. edges.  
from which:  
A fir, 20 ins. diam., bears N36°30'E, 89 lks. dist., mkd. "T36N R27W S25 BT".  
A fir, 6 ins. diam., bears S20°E, 32 lks. dist., mkd. "T36N R27W S36 BT".  
A fir, 12 ins. diam., bears S26°W, 56 lks. dist., mkd. "T36N R27W S35 BT".  
A pine, 38 ins. diam., bears N30°W, 42 lks. dist., mkd. "T36N R27W S26 BT".  
1959-60 B.L.M. Remonumentation Record by David R. Cunningham et. al.: The cor. of secs.25,26,35&36, monumented with a limestone, 14x12x8 ins., firmly set, mkd. as described in the original record, and witnessed by the remains of the original bearing trees. At the corner point, set an iron post, 30 ins. long, 2 1/2 in. diam., 26 ins. the ground, in concrete, with brass cap mkd. as shown:

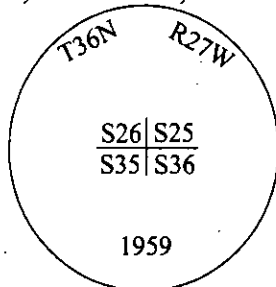

Established four new bearing trees:

- A fir, 8 ins. diam., bears N43 1/4°E, 16 lks. dist., mkd. "T36N R27W S25 BT".  
A fir, 5 ins. diam., bears S57 1/4°E, 21 lks. dist., mkd. "T36N R27W S36 BT".  
A fir, 5 ins. diam., bears S67°W, 22 lks. dist., mkd. "T36N R27W S35 BT".  
A fir, 9 ins. diam., bears N36°W, 74 lks. dist., mkd. "T36NR27W S26 BT".

- II. Bury the original stone alongside and raise a mound of stone, 3 ft. base, 2 ft. high, W. of the iron post. Found a 2 1/2 in. diam. iron pipe, firmly set, protruding 4 ins. above the ground, with a 3 1/4 in. diam. B.L.M brass cap mkd. as shown above. A 2.0 ft. diam. rock pile, West, 1.0 ft. dist. from the corner.  
from which:

- A rotten stump, 15 ins. diam., bears N37°E, 58.7 ft. dist., no visible marks. (GLO-record)  
A fir, 11 ins. diam., bears N44°E, 10.6 ft. dist., with a healed face. (BLM-record)  
A fir, 16 ins. diam., bears S21°E, 21.1 ft. dist., with visible scribe. (GLO-record)  
A fir, 9 ins. diam., bears S58°E, 13.9 ft. dist., with a healed face. (BLM-record)  
A stump, 16 ins. diam., bears S26°W, 36.1 ft. dist., no visible marks. (GLO-record)  
A fir, 9 ins. diam., bears S67°W, 14.5 ft. dist., with a healed face. (BLM-record)  
A rotten stump, bears N30°W, 27.7 ft. dist., with visible scribe. (GLO-record)  
A fir, 13 ins. diam., bears N36°W, 49.6 ft. dist., with a healed face. (BLM-record)

- III. Set a 6 ft. steel post, South, on property line, 3.0 ft. dist. from the corner, with Land Survey Monument and Property Boundary decals. Painted bearing trees and attached Land Survey Monument and Bearing Tree signs.  
Magnetic Declination: 20° East.

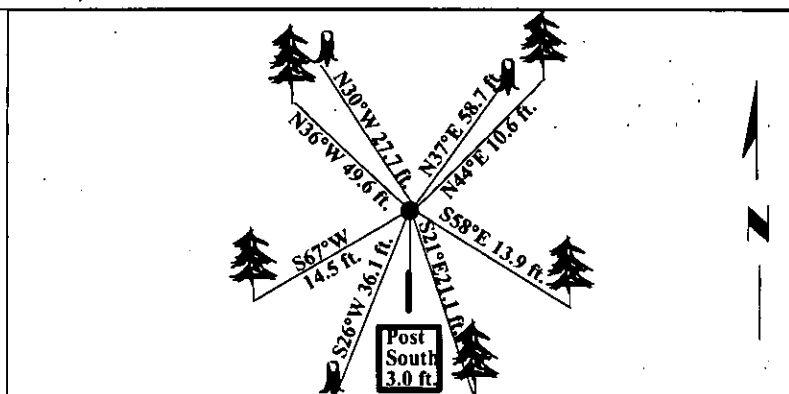

SKETCH OF CORNER

CERTIFICATION

I, Mark Federman  
certify the information shown herein is true and correct.

I, Ronald A. Pearson  
certify that this Corner Record correctly represents work performed by me or under my direction in compliance with the "Corner Recordation Act" (70-22-101, et seq., M.C.A.)

Signature of Surveyor & Seal

Date: 04/28/97

Reg. No.: 9008LS

Employer: U.S. FOREST SERVICE

Office of Clerk and Recorder, County of LINCOLN. This "corner record" was filed for record on JULY 31, 1997 was noted on the cross-index plat and is assigned page No. 9824 in book No. \_\_\_\_\_

CORAL M. CUMMINGS By RLB  
County Official

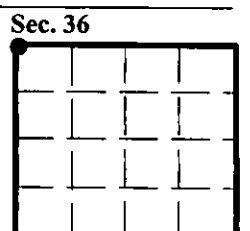

• corner this sheet

Cross Index No. V-21 T. 36N R. 27W P.M., MT