

CERTIFIED CORNER RECORDATION

Corner 1/4 Sec. 25&36 T. 36N R. 27W P.M., MT Lincoln County

I. 1893 G.L.O. Original Record by Peter McCardell et. al.: Set a lime stone, 16X12X7 ins., 11 ins. in the ground for 1/4 sec. cor. mkd. "1/4" on the N. face. Established two bearing trees.

1959-60 B.L.M. Remonumentaton Record by David R. Cunningham et. al.: The 1/4 sec. cor. of secs. 25 and 36, monumented with a limestone, 16x12x8 ins., firmly set, mkd. as described in the original record and witnessed by the remains of the original bearing trees. At the corner position, set an iron post, 30 ins. long, 2 1/2 in. diam., 27 ins. in the ground, in concrete, with the brass cap mkd. as shown:

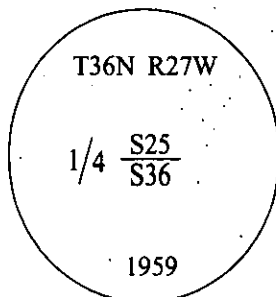

Established one new bearing tree:

A larch, 6 ins. diam., bears N62°W, 61 lks. dist., mkd. "1/4 S25 BT".

Bury the original stone alongside and raise a mound of stone, 2 1/2 ft. base, 1 1/2 ft. high, N. of the iron post.

II. Found a 2 1/2 in. diam. iron pipe, firmly set, protruding 5 ins. above the ground, with a B.L.M. brass cap mkd. as shown above. A 2 ft. rock pile, North, 1.0 ft. dist. from the corner.

from which:

A larch stump, 14 ins. diam., bears S31°W, 26.4 ft. dist., no visible marks. (GLO-record)

A larch, 10 ins. diam., bears N62°W, 40.7 ft. dist., mkd. with a healed face. (BLM-record)

A rotten stump, N66°W, 40.3 ft. dist., no visible marks. (GLO-record-N55°W)

III. Established one new bearing tree and one steel post:

A fir, 22 ins. diam., S20°W, 33.8 ft. dist., mkd. "1/4 S36 BT".

A 6 ft. steel post, North, on property line, 3.0 ft. dist. from the corner.

Painted bearing trees and attached Land Survey Monument and Bearing Tree signs.

Attached Land Survey Monument and Property Boundary decals to post.

Magnetic Declination: 20° East.

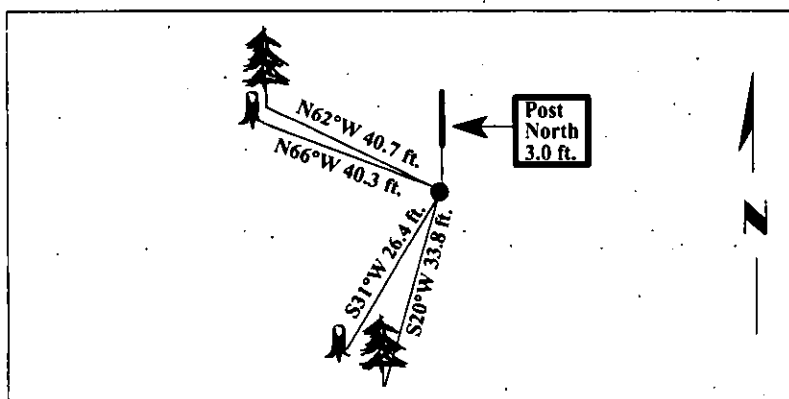

SKETCH OF CORNER

CERTIFICATION

I, Mark Federman
certify the information shown herein is true and correct.

I, Ronald A. Pearson
certify that this Corner Record correctly represents work performed by me or under my direction in compliance with the "Corner Recordation Act" (70-22-101, et seq., M.C.A.)

Signature of Surveyor & Seal

Date: 04/28/97

Reg. No.: 9008LS

Employer: U.S. FOREST SERVICE

Office of Clerk and Recorder, County of LINCOLN. This "corner record" was filed for record on JULY 31, 1997 was noted on the cross-index plat and is assigned page No. 9823 in book No. CORAL M. CUMMINGS By RLB

County Official

Sec. 36

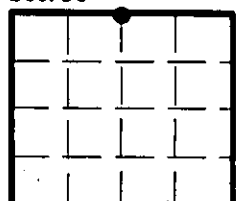

• - corner this sheet

Cross Index No. V-23 T. 36N R. 27W P.M., MT