

CERTIFIED CORNER RECORDATION

Corner 1/4 Sec. 21&22 T. 36N R. 27W P.M., MT Lincoln County

- I. 1893 G.L.O. Original Record by Peter McCardell et. al.: Set a sandstone, 12X12X5 ins., 8 ins. in the ground for 1/4 sec. cor. mkd. "1/4" on the N. face.

Established two bearing trees:

- A pine, 26 ins. diam., bears S29°E, 87 lks. dist., mkd. "1/4 S BT".
A pine, 28 ins. diam., bears S56°30'W, 76 lks. dist., mkd. "1/4 S BT".

1970 B.L.M. Remonumentation Record by Joseph E. French: The 1/4 sec. cor. of secs. 21 and 22, as determined by the remains of the original bearing trees. At the corner position, set an iron post, 30 ins. long, 2 1/2 in. diam. aluminum post, 24 ins. in the ground, with the cap mkd. as shown:

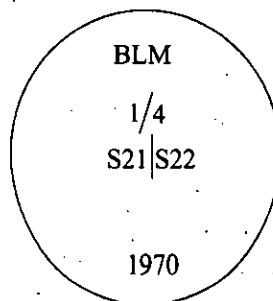

Established two new bearing trees:

- A pine, 11 ins. diam., bears S38 3/4°E, 65 lks. dist., mkd. "1/4 S22 BT".
A pine, 16 ins. diam., bears S40 3/4°W, 126 lks. dist., mkd. "1/4 S21 BT".

Raise a flat mound of stone, 6 ft. diam., around the iron post.

- II. Found a 2 1/2 in. diam. aluminum pipe, firmly set, protruding 2 ins. above the ground, in a rock collar, with a 3 1/4 in. diam. B.L.M. brass cap mkd. as shown above.

from which:

- A pine, 19 ins. diam., bears S38°45'E, 42.9 ft. dist., with a healed face. (BLM-record)
A pine, 24 ins. diam., bears S40°45'W, 83.1 ft. dist., with a healed face. (BLM-record)

- III. Set a 6 ft. steel post, East, on property line, 1.0 ft. dist. from the corner, with a Land Survey Monument decal attached.

Painted bearing trees and attached Land Survey Monument and Bearing Tree signs.

Magnetic Declination: 20° East.

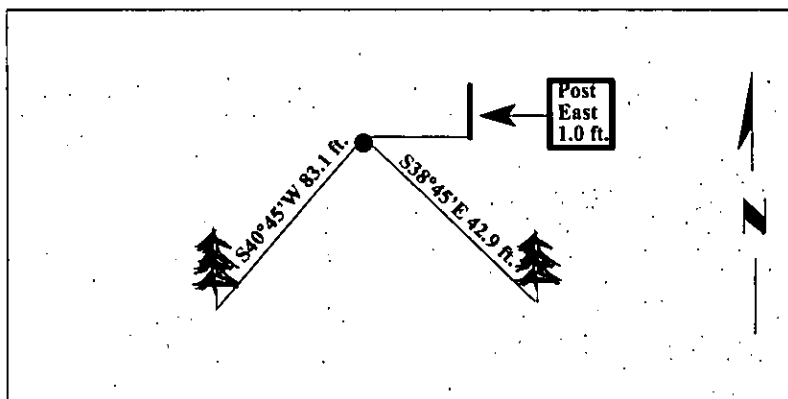

SKETCH OF CORNER

CERTIFICATION

I, Mark Federman certify the information shown herein is true and correct.

I, Ronald A. Pearson certify that this Corner Record correctly represents work performed by me or under my direction in compliance with the "Corner Recordation Act" (70-22-101, et seq., M.C.A.)

Signature of Surveyor & Seal

Date: 04/23/97

Reg. No.: 9008LS

Employer: U.S. FOREST SERVICE

Office of Clerk and Recorder, County of LINCOLN. This "corner record" was filed for record on JULY 31, 1997 was noted on the cross-index plat and is assigned page No. 9822 in book No. _____

CORAL M. CUMMINGS By RLB
County Official

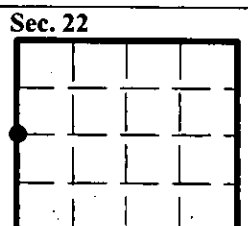

• - corner this sheet