

CERTIFIED LAND CORNER RECORDATION

DESCRIPTION OF CORNER EVIDENCE FOUND, AND ORIGINAL RECORD (IF KNOWN)

FOUND BRASS CAP BY CORE OF ENG. FROM WHICH;
 10" FIR BEARS N55°15'W 87.5 LKS MARKED RM.
 10" FIR BEARS S25°55'W 50 LKS MARKED RM

DESCRIPTION OF MONUMENT AND ACCESSORIES ESTABLISHED
 TO PERPETUATE THE ORIGINAL LOCATION OF THIS CORNER:

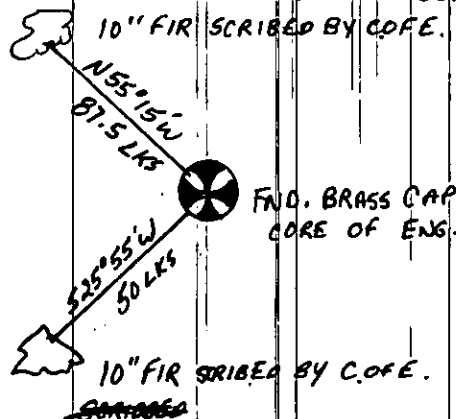

Date of work: 7-24-79

SKETCH, WITH COURSE AND DISTANCE TO ADJACENT CORNERS IF DETERMINED IN THIS SURVEY.
 (MAY SKETCH OR PASTE REPRODUCTION ON REVERSE SIDE.)

Surveyor's Seal

I, Tom SANDS
 certify that the information shown herein is true and correct.

Signature of Ground Party Chief

I, C.W. DOYLE
 certify that I have carefully performed or reviewed the work done on the diagrammed corner as reported on this recordation form and approve the same.

C. W. Doyle
 Signature of Surveyor

DIAGRAM OF CORNER:

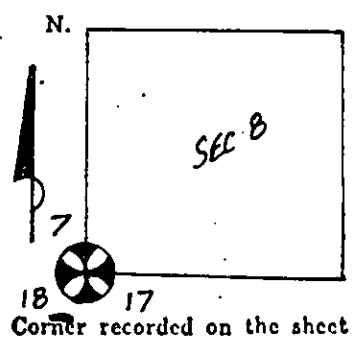

2516-S
 Registration Number

Clerk and Recorder, County of Lincoln
 "record" was filed for record on the 24th day of July, 1979, was noted on the cross-index plat and is
 page No. 869, in book No. _____

Edward L. Tangles by Betty Sire,
 County Official

Cross Index No. J5 T. 36N R. 27W Mer.