

CERTIFIED LAND CORNER RECORDATION --

DESCRIPTION OF CORNER EVIDENCE FOUND, AND ORIGINAL RECORD (IF KNOWN)

ORIGINAL G.L.O. NOTES: "Set a limestone, 16 X 12 X 6 ins. 11 ins. in the ground, for Cor. to Secs. 13, 18, 19 & 24 marked with 3 notches on N. and ~~notches on S. edges.~~ dug pits 18X18X12 ins. in each Sec. 5 1-2ft. dist. and raised a mound of earth 2ft. high, 4 1-2 ft. base alongside."

FOUND: NO ORIGINAL EVIDENCE FOUND

DESCRIPTION OF MONUMENT AND ACCESSORIES ESTABLISHED TO PERPETUATE THE ORIGINAL LOCATION OF THIS CORNER:

This corner was set at a proportional distance from two existing corners.

Date of work: JUNE 1977

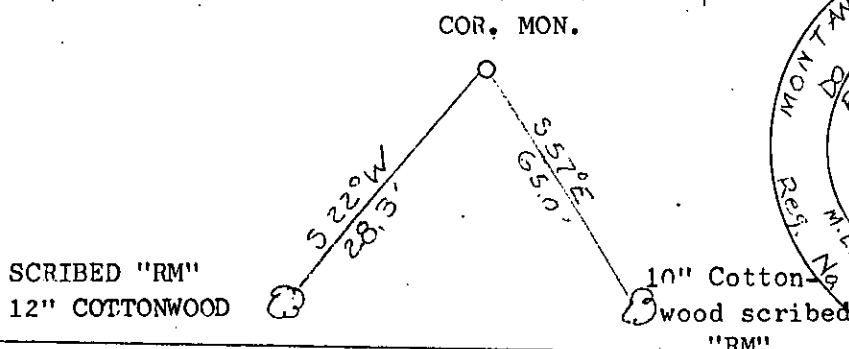

SKETCH, WITH COURSE AND DISTANCE TO ADJACENT CORNERS IF DETERMINED IN THIS SURVEY. (MAY SKETCH OR PASTE REPRODUCTION ON REVERSE SIDE.)

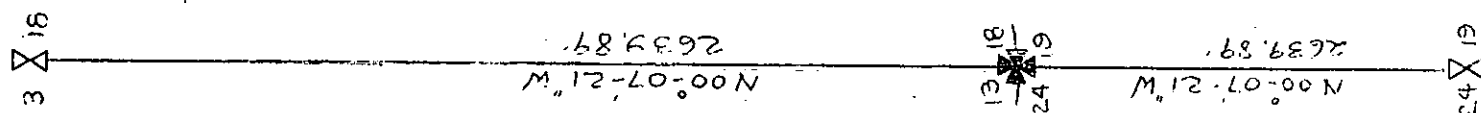

Surveyor's Seal

I, JAMES BURTON
certify that the information shown herein is true and correct.

Signature of Ground Party Chief

I, M. L. HAIGES
certify that I have carefully performed or reviewed the work done on the diagrammed corner as reported on this recordation form and approve the same.

Signature of Surveyor

DIAGRAM OF CORNER:

R27N T36N R26N
N.

13 18
24 19

S.W. COR. SEC. 18

X = Corner recorded on the sheet

2520 S
Registration Number

of Clerk and Recorder, County of Lincoln

"corner record" was filed for record on the 13th day of April 1978, was noted on the cross-index plat and is
led page No. 519, in book No.

25-45227 see original 36-26

Cross Index No. 1-N T. 36 R. Mer.
N-25

Salvatore L. Vanghan, by Betty Seel
County Official Deputy