

CERTIFIED LAND CORNER RECORDATION

DESCRIPTION OF CORNER EVIDENCE FOUND, AND ORIGINAL RECORD (IF KNOWN)

NOTHING FOUND. Set 5/8" IR W/CAP STAMPED DOYLE-2516-5
BY SINGLE PROPORTION.

DESCRIPTION OF MONUMENT AND ACCESSORIES ESTABLISHED
TO PERPETUATE THE ORIGINAL LOCATION OF THIS CORNER:

Date of work: JAN-1978

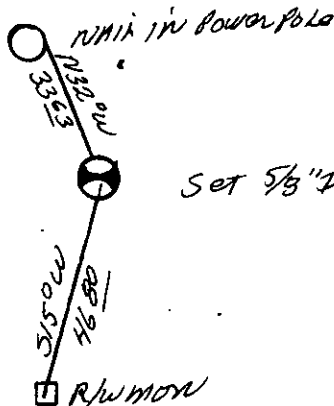

Set 5/8" IR W/CAP STAMPED DOYLE-2516-5

SKETCH, WITH COURSE AND DISTANCE TO ADJACENT CORNERS IF DETERMINED IN THIS SURVEY.
(MAY SKETCH OR PASTE REPRODUCTION ON REVERSE SIDE.)

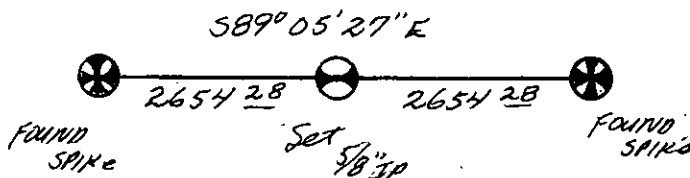

Surveyor's Seal

I, _____
certify that the information shown herein is true and correct.

Thomas E. Gander

Signature of Ground Party Chief

I, C. W. Doyle
certify that I have carefully performed or reviewed the work done on the diagrammed corner as reported on this recordation form and approve the same.

C. W. Doyle

Signature of Surveyor

DIAGRAM OF CORNER:

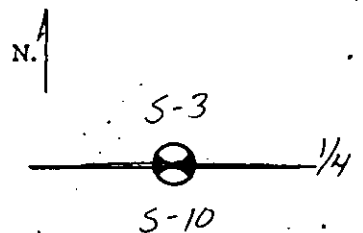

⊙ = Corner recorded on the sheet

2516-5
Registration Number

Office of Clerk and Recorder, County of Lincoln
This "corner record" was filed for record on the 31st day of January, 1978, was noted on the cross-index plat and is assigned page No. 513, in book No. 1
Clerk L. D. Taylor, by Betty Bee, Deputy
County Official
Cross Index No. E-15 T. 36N R. 27W Mer.