

- INSTRUCTIONS
1. Original and subsequent record used to evaluate the corner position.
 2. Description of evidence found, note discrepancies in the record, state method of establishing lost or obliterated corners.
 3. Description of monument and accessories set to perpetuate the corner position.
 4. Sketch or corner, show all pertinent data which can best be shown in a sketch example, corner marking, topography ties, position of accessories, etc.
 5. Certification must be signed and sealed by Registered Land Surveyor in State of Montana.
 6. Fill in Cross Index & Section Diagram at bottom of sheet.

CERTIFIED CORNER RECORDATION

Corner N.E. Cor. Sec. 34 T. 36 N. R. 27 W. P.M.M. Lincoln County

ORIGINAL RECORD G.L.O. 1893

Set a post 4 ft. long, 4 ins. square, 24 ins. in the ground for cor. of secs. 26, 27, 34 & 35 mkd. T36N S 26 on N.E., R27W S 35 on S.E., S 34 on S.W., and S 27 of N.W. faces, with 1 notch on the S and 2 notches on the E. edges, from which:

- A fir, 9 ins. diam., bears N 78° E, 86 lks. dist., mkd. T36N R27W S26 BT.
- A fir, 9 ins. diam., bears S 60° 30' E, 41 lks. dist., mkd. T36N R27W S35 BT.
- A fir, 14 ins. diam., bears S 59° 30' W, 36 lks. dist., mkd. T36N R27W S34 BT.
- A fir, 6 ins. diam., bears N 39° W, 81 lks. dist., mkd. T36N R27W S27 BT.

B.L.M. REMONUMENTATION 1960

The cor. of secs. 26, 27, 34 and 35, as determined from the remains of two of the original bearing trees.

At the corner point, Set an iron post, 30 ins. long, 2 1/2 ins. dia., 28 ins. in the ground, in concrete, with brass cap mkd.

T36N R27W from which the remains of the original bearing trees:

- S 27 | S 26 A fir, 18 ins. dia., bears S 60 1/2° E, 41 lks. dist., mkd. T36N R27W S 25 BT. (Rec)
- S 34 | S 35 A stump, 22 ins. dia., bears S 59 1/2° W, 36 lks. dist. (Rec)

The new bearing trees:

- 1960 A fir, 12 ins. dia., bears N 42 3/4° E, 33 lks. dist., mkd. T36N R27W S 26 BT.
- A fir, 6 ins. dia., bears S 57 1/2° W, 57 lks. dist., mkd. T36N R27W S 34 BT.
- A fir, 6 ins. dia., bears N 43 1/2° W, 69 lks. dist., mkd. T36N R27W S 27 BT.

Raise a mound of stone, 3 ft. base, 2 ft. high, W. of the iron post.

EVIDENCE FOUND

Found a BLM brass cap, mkd. as shown above, from which:

- A fir, 18 ins. dia., bears S 60° 30' E, 26.8 ft. dist., mkd. with an overgrown blaze. (GLO 1893 BT)
- The rotted remains of a stump, bears S 59° 30' W, 23.6 ft. dist. (GLO 1893 BT)
- The GLO 1893 BT to the N.E. was searched for and not found.
- A fir, 19 ins. dia., bears N 42 3/4° E, 22.0 ft. dist., mkd. with an overgrown blaze. (BLM 1960 BT)
- A fir, 9 ins. dia., bears S 57° 30' W, 37.7 ft. dist., mkd. with an overgrown blaze. (BLM 1960 BT)
- A fir, 12 ins. dia., bears N 43° 30' W, 45.5 ft. dist., mkd. with an overgrown blaze. (BLM 1960 BT)
- A foot crown and rotted remains, with visible scribing, bears N 39° W, 53.5 ft. dist. (GLO 1893 BT)
- A mound of stone W. of the brass cap.

CORNER PERPETUATION

Set a galvanized steel post with a Survey Marker decal, 3 ft. North of the brass cap. Painted red bands around the bearing trees and painted the scribing and blazing. Attached bearing tree signs and Land Survey Monument signs.

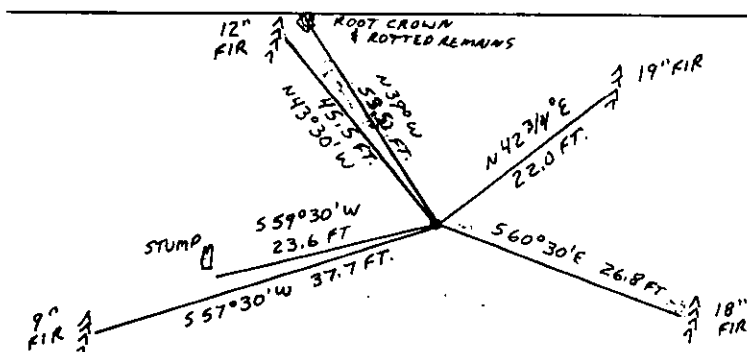

DECL. 21° E. SKETCH OF CORNER

CERTIFICATION

I, _____
certify the information shown herein is true and correct.

Signature Ground Party Chief

I, Philip A. Helps
certify that this Corner Record correctly represents work performed by me or under my direction in compliance with the "Corner Recordation Act" (70-2-101 et seq., M.D.A.)

Signature of Surveyor & Seal

Date: 10/87 Reg. No. 4739 S

Employer: F & H Land Surveying, Whitefish

Office of Clerk and Recorder, County of Lincoln. This "corner record" was filed for record on the Nov 30 day of 1987, was noted on the cross-index plat and is assigned page No. 3723, in book No. _____

Just B. Sigel by Bill Sigel
County Official Deputy

Cross Index No. V - 17 T. 36 N R. 27 W PMM

Sec. 34

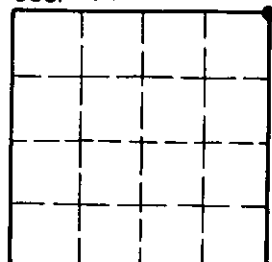

• - corner this sheet