

- INSTRUCTIONS
1. Original and subsequent record used to evaluate the corner position.
  2. Description of evidence found, note discrepancies in the record, state method of establishing lost or obliterated corners.
  3. Description of monument and accessories set to perpetuate the corner position.
  4. Sketch or corner, show all pertinent data which can best be shown in a sketch example, corner marking, topography ties, position of accessories, etc.
  5. Certification must be signed and sealed by Registered Land Surveyor in State of Montana.
  6. Fill in Cross Index & Section Diagram at bottom of sheet.

## CERTIFIED CORNER RECORDATION

Corner S.E. Cor. of Section 35 T. 36 N. R. 27 W. P.M.M. Lincoln County

### ORIGINAL RECORD G.L.O. 1893

Set a sand stone, 14x10x6 ins., 10 ins. in the ground, for Cor. to Secs. 1, 2, 35 & 36 marked with 1 notch on the E. and 5 notches on the W. edges. from which:

- A fir, 9 ins. in dia., bears N 32° 30' E, 78 lks. dist., mkd. T36N R27W S 36 BT.
- A tamarack, 12 ins. in dia., bears S 44° E, 58 lks. dist., mkd. T35N R27W S 1 BT.
- A fir, 20 ins. in dia., bears S 32° W, 44 lks. dist. mkd., T35N R27W S 2 BT.
- A fir, 24 ins. in dia., bears N 44° W, 33 lks. dist. mkd., T36N R27W S 35 BT.

### B.L.M. REMONUMENTATION 1960

The cor. of Secs. 35 and 36, on the S bdy. of the Tp., monumented with a limestone, 10x8x6 ins., firmly set, mkd. with 1 groove on the E. and 5 grooves on the W. faces, and witnessed by the remains of the original bearing trees.

At the corner point, Set an iron post, 30 ins. long, 2 1/2 ins. diam., 28 ins. in the ground, in concrete, with brass cap mkd.

T36N R27W from which the remains of the original bearing trees:

S35/S36  
S 1 A fir, 17 ins. diam., bears N 32 1/2° E, 78 lks. dist., mkd. with an overgrown blaze. (Record)

T35N R27W  
1960 A stump, 24 ins. diam., bears N 44° W, 33 lks. dist., (Record)

The new bearing tree:

A fir, 6 ins. diam., bears N 28 3/4° W, 72 lks. dist., mkd. T36N R27W S 35 BT.

Bury the original stone alongside and raise a mound of stone, 3 ft. base, 2 ft. high, N. of the iron post.

EVIDENCE FOUND - Found a BLM brass cap, flush with the ground, mkd. as shown above, from which:

A fir, 20 ins. diam., bears N 32° 30' E, 51.3 ft. dist., mkd. with an overgrown blaze. (G.L.O. 1893 BT)

A stump hole, with stump lying alongside, no scribing visible, bears S 44° E, 38.3 ft. dist. (G.L.O. 1893 BT)

A stump, 26 ins. diam., bears S 32° W, 27.6 ft. dist., with scribing visible. (GLO 1893 BT)  
(Note: There is also scribing visible on the N.W. face of the stump for the closing corner of Secs. 1 and 2, T35N R27W)

(OVER)

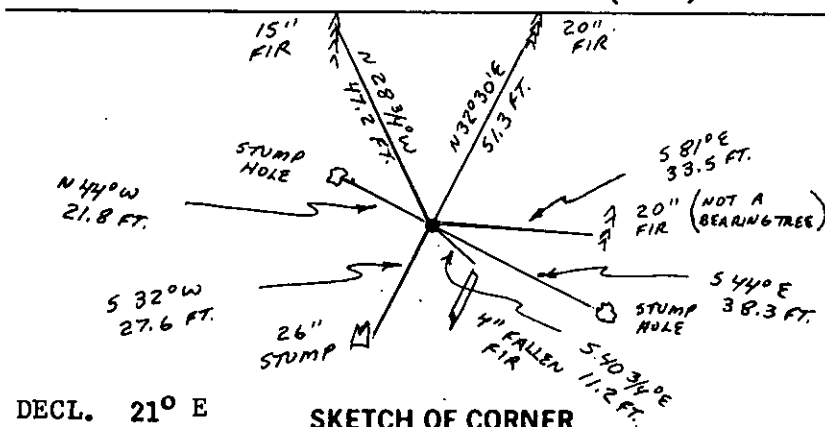

### CERTIFICATION

I, \_\_\_\_\_  
certify the information shown herein is true and correct.

Signature Ground Party Chief

**Philip A. Helps**

I, \_\_\_\_\_  
certify that this Corner Record correctly represents work performed by me or under my direction in compliance with the "Corner Recordation Act" (70-22-101, et seq., M.D.A.)

Signature of Surveyor & Seal

Date: 9/87 Reg. No. 4739 S

Employer: F & H Land Surveying, Whitefish

Office of Clerk and Recorder, County of Lincoln. This "corner record" was filed for record on the October 6 day of 1987, was noted on the cross-index plat and is assigned page No. 3671, in book No. \_\_\_\_\_

Cross Index No. Z - 21 T. 36 N. R. 27 W. PMM

Sec. 35

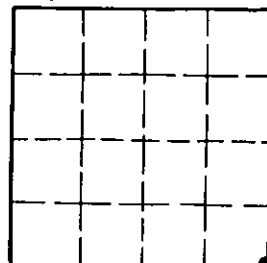

• - corner this sheet

(CONT'D)

A stump hole bears N  $44^{\circ}$  W, 21.8 ft. dist., no remains of stump or scribing visible.  
(GLO 1893 BT)

A fir, 15 ins. diam., bears N  $28 \frac{3}{4}^{\circ}$  W, 47.2 ft. dist., mkd. with an overgrown blaze.  
(BLM 1960 BT)

A fallen fir, 4 ins. diam., bears S  $40 \frac{3}{4}^{\circ}$  E, 11.2 ft. dist., mkd. T35N R27W S 1 BT. A B.L.M. bearing tree sign is attached which reads N  $40 \frac{3}{4}^{\circ}$  E, 17 lks. T35N R27W S 1. There is no previous record of this tree being a bearing tree.

A fir, 20 ins. diam., bears S  $81^{\circ}$  E, 33.5 ft. dist., with an open blaze painted red. There is no previous record of this tree being a bearing tree and no bearing tree signs were attached. I have included it in this record to avoid possible confusion for future surveyors.

#### CORNER PERPETUATION

Set a galvanized steel guard post with a Survey Marker decal 3 ft. west of the brass cap. Painted red bands around the bearing trees and painted the blazing and scribing. Attached bearing tree signs and Land Survey Monument signs