

INSTRUCTIONS

1. Original and/or subsequent record used to evaluate the corner position.
2. Description of evidence found, note discrepancies in the record, state method of establishing lost or obliterated corners.
3. Description of monument and accessories set to perpetuate the corner position.
4. Sketch or corner, show all pertinent data which can best be shown in a sketch example, corner marking, topography ties, position of accessories, etc.
5. Certification must be signed and sealed by Registered Land Surveyor in State of Montana.
6. Fill in Cross Index & Section Diagram at bottom of sheet.

• CERTIFIED CORNER RECORDATION

Corner Sec. Cor. Sections 1 & 12 T. 36N R. 27W P.M.M. Lincoln County
Sections 6 & 7 T 36N R 26W

Record: Set a limestone 15x10x4 ins. 10 ins in the ground from which:

- a pine 20 ins. diam. bears N. 35° E. 130 lks.
- a pine 18 ins. diam. bears S. 79° E. 251 lks.
- a pine 26 ins. diam. bears S. 34° 30' W. 238 lks.
- a pine 15 ins. diam. bears N. 68° 30' W. 368 lks.

Found 1 original bearing tree. Set aluminum monument

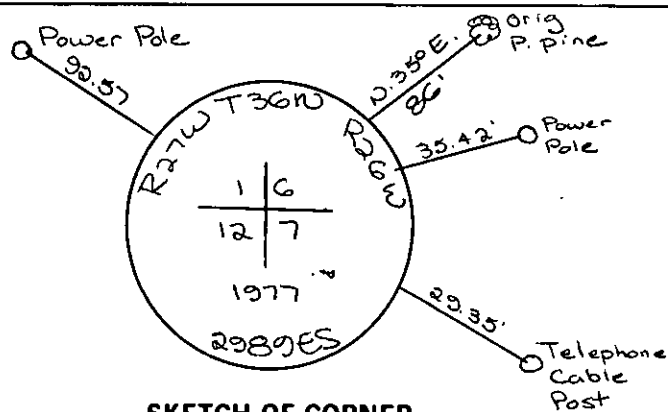

SKETCH OF CORNER

CERTIFICATION

I, _____
 certify the information shown herein is true and correct.

Signature Ground Party Chief

I, D.K. Marquardt
 certify that this Corner Record correctly represents work performed by me or under my direction in compliance with the "Corner Recordation Act" (70-22-101, et seq., M.D.A.)

D.K. Marquardt
 Signature of Surveyor & Seal

Date: 7-10-81 Reg. No. 2389ES

Employer: _____

Office of Clerk and Recorder, County of Lincoln. This "corner record" was filed for record on the 12th August day of 1981, was noted on the cross-index plat and is assigned page No. 1200, in book No. 1

Cross Index No. E-1 T. 36N R. 26W P.M.M.
E-25 T 36N R 27W

Sec. 1

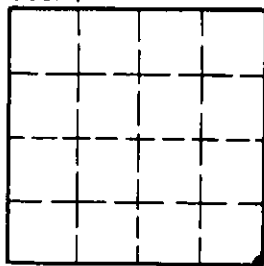

• - corner this sheet