

CERTIFIED LAND CORNER RECORDATION

DESCRIPTION OF CORNER EVIDENCE FOUND, AND ORIGINAL RECORD (IF KNOWN)

No corner evidence found or original recordation information found, as this corner is the center of section.

DESCRIPTION OF MONUMENT AND ACCESSORIES ESTABLISHED TO PERPETUATE THE ORIGINAL LOCATION OF THIS CORNER:

Date of work: Sept. 1980

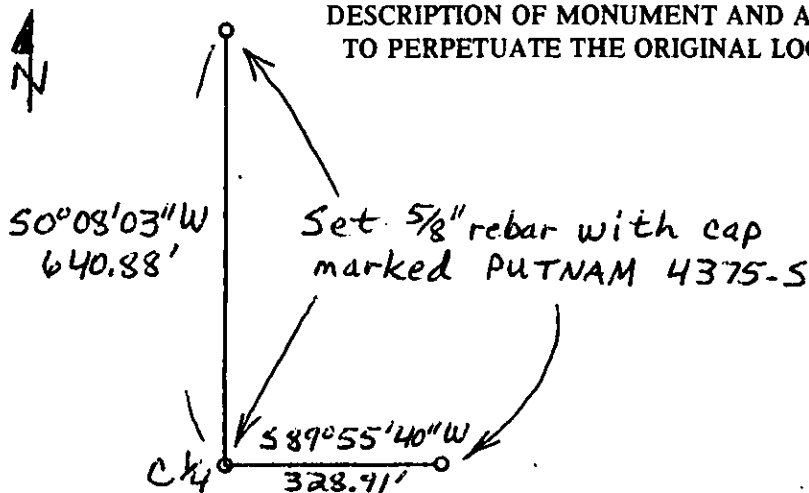

SKETCH, WITH COURSE AND DISTANCE TO ADJACENT CORNERS IF DETERMINED IN THIS SURVEY. (MAY SKETCH OR PASTE REPRODUCTION ON REVERSE SIDE.)

See Reverse Side ; also, see C.O.S. #105

Surveyor's Seal

I, Ralph Putnam
certify that the information shown herein is true and correct.
Ralph Putnam
Signature of Ground Party Chief

I, Albert R. Putnam
certify that I have carefully performed or reviewed the work done on the diagrammed corner as reported on this recordation form and approve the same.
Albert R. Putnam
Signature of Surveyor

4375-S
Registration Number

DIAGRAM OF CORNER:

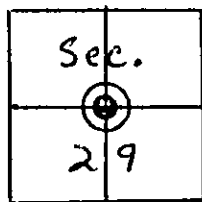
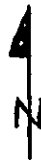

= Corner recorded on the sheet
Center 4 Sec. 29
T36N R27W

Office of Clerk and Recorder, County of Lincoln

This "corner record" was filed for record on the 6th day of August 1981, was noted on the cross-index plat and is assigned page No. 1178, in book No. 1.

Cleaner L. Vaughan, My Deputy
County Official Deputy

Cross Index No. T-7 T 36 R 27 Mer.

