

## INSTRUCTIONS

1. Original and/or subsequent record used to evaluate the corner position.
2. Description of evidence found, note discrepancies in the record, state method of establishing lost or obliterated corners.
3. Description of monument and accessories set to perpetuate the corner position.
4. Sketch or corner, show all pertinent data which can best be shown in a sketch example, corner marking, topography ties, position of accessories, etc.
5. Certification must be signed and sealed by Registered Land Surveyor in State of Montana.
6. Fill in Cross Index & Section Diagram at bottom of sheet.

• **CERTIFIED CORNER RECORDATION**

Corner Sec. Cor 5, 6, 7 & 8 T. 36N R. 27W P.M.M. Lincoln County

Record:

Set a post 4' long, 24" in the ground from which:

a pine 14" dia. bears N. 27° 30' E. 84 lks

a pine 22" dia. bears S. 13° E. 140 lks

a pine 8" dia. bears S. 40° W. 103 lks

Found original BT stumps

Set brass cap

See C. of S. No. 541 for adjacent corners

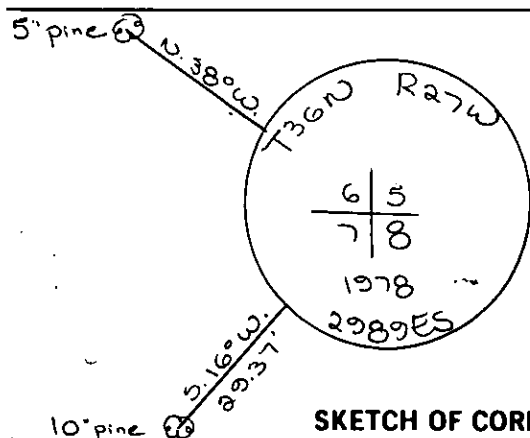

**SKETCH OF CORNER**

**CERTIFICATION**

I, \_\_\_\_\_  
certify the information shown herein is true and correct.

Signature Ground Party Chief

I, D.K. Marquardt  
certify that this Corner Record correctly represents work performed  
by me or under my direction in compliance with the "Corner  
Recordation Act" (70-22-101, et seq., M.D.A.)

Signature of Surveyor & Seal

Date: 2-6-81 Reg. No. 2989ES

Employer: \_\_\_\_\_

Office of Clerk and Recorder, County of Lincoln This "corner  
record" was filed for record on the 17th July day of 1981  
was noted on the cross-index plat and is assigned page No. 1149 In  
book No. 1 Thomas L. Taupen, by Scott Seal,  
County Official Deputy

Cross Index No. E-5 T. 36N R. 27W P.M.M.

Sec. 5

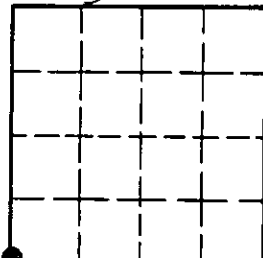

• - corner this sheet