

INSTRUCTIONS

1. Original and/or subsequent record used to evaluate the corner position.
2. Description of evidence found, note discrepancies in the record, state method of establishing lost or obliterated corners.
3. Description of monument and accessories set to perpetuate the corner position.
4. Sketch of corner, show all pertinent data which can best be shown in a sketch example, corner marking, topography ties, position of accessories, etc.
5. Certification must be signed and sealed by Land Surveyor registered in the State of Montana.
6. Fill in Cross Index & Section Diagram at bottom of sheet.

CERTIFIED CORNER RECORDATION

Corner E 1/4 Sec. 6 1/5 T. 36 N R. 26 W P.M.M. Lincoln County

RECORD:

1893 Township Subdivisions by U.S. Deputy Surveyors Peter McCardell and Abram L. Jaqueth.

"40 chs. set a sandstone 18x8x4 ins., 12 ins. in the ground, for 1/4 sec. cor. marked 1/4 on W face from which:

A Fir 8 ins. diam. bears S 78° E 39 lks. dist. marked 1/4 S. B.T.

A Fir 10 ins. diam. bears S 27° W 37 lks. dist. marked 1/4 S. B.T.

FOUND:

During a field search of area, a limestone 18 ins. long by 12 ins. wide by 6 ins. thick with 1/4 scribed on west face was found loosely set under an old existing 3 strand barbwire fence, from which:

A well rotted Douglas Fir stump bears S 74° E 24.27 ft. dist. (S 78° E 25.74 feet GLO record). No visible scribing.

A stump hole bears S 41° W 25.40 ft. dist. (S 27° W 24.64 ft. GLO record), but due to logging activity in this area, no stump remains for identification.

MAINTENANCE:

I accept the found stone and its position and replace it with a 3 1/4 inch diam. alum. cap on a 2 inch diam. alum. pipe 30 ins. long, 26 ins. in the ground marked as shown below, from which I establish two new Bearing Trees described as follows:

A Douglas Fir 12 ins. diam. bears N 30° W 51.90 ft. dist. scribed (1/4 S6 BT).

A Douglas Fir 10 1/2 ins. diam. bears N 22° E 39.50 ft. dist. scribed (1/4 S5 BT).

Paint scribed faces red and 6 inch wide red bands around both Bearing Trees.

I buried original found stone in a raised collar of stone around the new monument.

Attached Bearing Tree signs to both trees.

The above monument is located under a three strand barbwire fence bearing east and west and a three strand barbwire fence bearing north-south bears east 6 ft. dist.

Decination 18° E

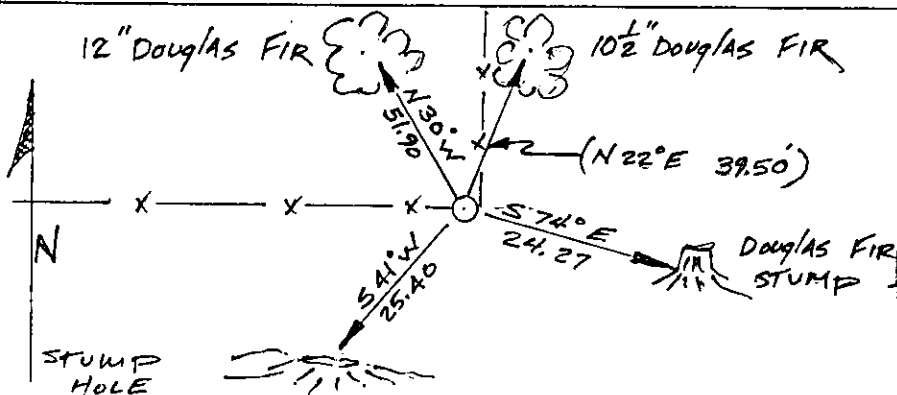

SKETCH OF CORNER

CERTIFICATION

I, John Damon,
certify the information shown herein is true and correct.

John Damon
Signature Ground Party Chief

I, Ken E. Davis,
certify that this Corner Record correctly represents work performed
by me or under my direction in compliance with the "Corner
Recordation Act" (70-21-107, et seq., M.C.A.)

Ken E. Davis
Signature of Surveyor & Seal

Date 3-17-97 Reg. No. 4975-S

Employer: Davis Surveying, Inc.

Office of Clerk and Recorder, County of LINCOLN. This "corner
record" was filed for record on April 11, 1997
was noted on the cross-index plat and is assigned page No. 9248, in
book No. CORAL M. CUMMINGS

County Official B. O. B.

Sec. 6 1/5

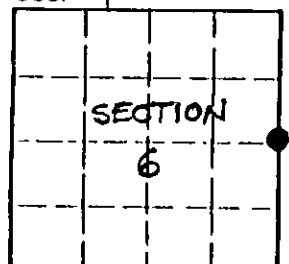

Cross Index No. E 1/4 S6 S5 T. 36 N. R. 26 W. P.M.M.

• corner this sheet

INSTRUCTIONS TO SURVEYORS FOR COMPLETION OF CERTIFIED CORNER RECORDATION FORMS

I. ORIGINAL AND/OR SUBSEQUENT RECORD:

This item should describe or quote those portions of the original or subsequent record which were used in evaluating the corner position. The original record will usually be the General Land Office field notes. Subsequent record can come from several sources: Previously filed corner records, maps and plats, private and public records, etc. Some of the subsequent record, even though not in the public record, but known to have validity by the surveyor, may be quoted and appropriately noted.

The record data helps support the reestablished corner position because it clearly shows what history the surveyor based his corner position on. In some cases, however, the record may be unknown or not pertinent. A statement to that effect should appear on the corner record.

II. DESCRIPTION OF EVIDENCE FOUND OR METHOD OF LOCATING CORNER POSITION:

This item will describe the original or subsequent record evidence found. If portions of the found evidence cannot be reconciled with the record, then the disregarded record should be noted, and, if possible, an opinion as to its cause narrated.

If no physical evidence of the original or subsequent monuments and accessories can be found, then the method used to reestablish the lost or obliterated corner (single proportion, fence intersection, parol evidence, terrain calls, centerline of road, etc.) shall be indicated.

III. DESCRIPTION OF MONUMENTS AND ACCESSORIES SET TO PERPETUATE THE CORNER POSITION:

This item should list all details about the corner and its location which will help exclusively identify the corner position; including size and type of monument, how marked if not shown in sketch, and distinguishing topographic calls which help locate the corner. In many cases, instructions on how to find the corner should be included.

References or ties to other corners are optional and may be drawn on the face or back of the corner record form, or references to Certificate of Survey may be made. Separate drawings may be attached to the corner form.

If state plane coordinate values for the corner position are shown, then the control upon which they are based should be indicated.

IV. SKETCH OF CORNER:

This item will usually show how a found or set corner is marked and may also show topography or accessory monuments found or set and their relation to the corner. There is no stipulated format; the sketch could be transcribed field note entries.

V. CERTIFICATION:

The name and signature of the ground party chief is optional.

The Surveyor who performed or directed the field work which is depicted on the "Certified Corner Record" shall sign and affix his seal in the Certification.

The employer blank is optional but useful in tracking down original field note data or adjacent record if, in the future, questions arise about the corner.

VI.

The Cross Index at the bottom of the page should be completed by the Surveyor. Only the single Township Index where the corner is filed shall be completed.

The lower righthand corner is a corner location diagram and should have the pertinent section filled in at the top and a closed circle indicating the appropriate corner position in the section filled in. This is intended to be an aid in searching the "Record" once it has been filed.