

INSTRUCTIONS

1. Original and/or subsequent record used to evaluate the corner position.
2. Description of evidence found, note discrepancies in the record, state method of establishing lost or obliterated corners.
3. Description of monument and accessories set to perpetuate the corner position.
4. Sketch of corner, show all pertinent data which can best be shown in a sketch example, corner marking, topography ties, position of accessories, etc.
5. Certification must be signed and sealed by Land Surveyor registered in the State of Montana.
6. Fill in Cross Index & Section Diagram at bottom of sheet.

CERTIFIED CORNER RECORDATION

Corner E¹/₄ Corner (SEC. 35) T. 36N. R. 26W. P.M.M. LINCOLN County

RECORD: from GLO Book 2841, page 2:

Set a limestone 17" x 12" x 8", 12" in the ground, marked 1/4 on west face, from which:

a 16" fir bears N43°E 16 lks. (10.6')

a 8" pine bears N58°W 54 lks. (35.6')

From C.O.S. 1572 by Marquardt 2989ES, says: "Found bearing trees, set 2 1/2" aluminum monument"

FOUND: 40 d spike fitting swing ties from info on new BT tags posted by "RGR 5/6/87" (see C.O.S. 1572 from May 1987).

G.L.O. evidence:

remains of rotten stump center at N43°E 10.6'

also orig. stone marked 1/4 laying on top of ground next to found 40d spike.

Other evidence:

a 11" larch with spike up 1.5' on west side and BT tag on tree saying "1/4 cor. bears N07°E 22.59' posted by RGR 5/7/87"

a 9" larch with spike up 1.0' on north side and BT tag on tree saying "1/4 cor. bears EAST 50.85' posted by RGR 5/7/87"

SET: Accepted 40d spike as 1/4 corner position, removed 40d spike, at same place set 5/8" rebar with 1 1/2" yellow plastic cap marked "BRIEN 7681 S", buried orig stone face up along west side of set pin. Set steel fence post 0.5' east of set rebar.

Used a SILVA hand compass (declination 19°E)

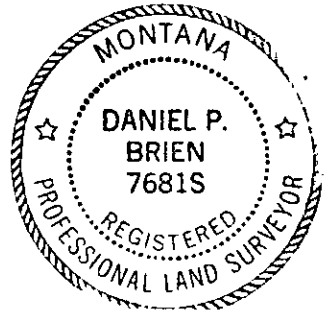

2" B.C.
SEE BRIEN
COR. REC.

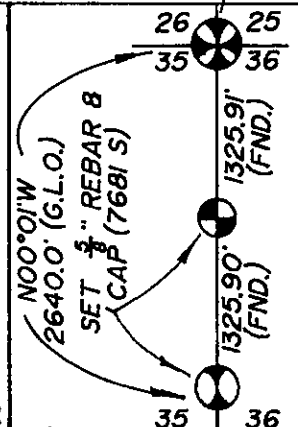
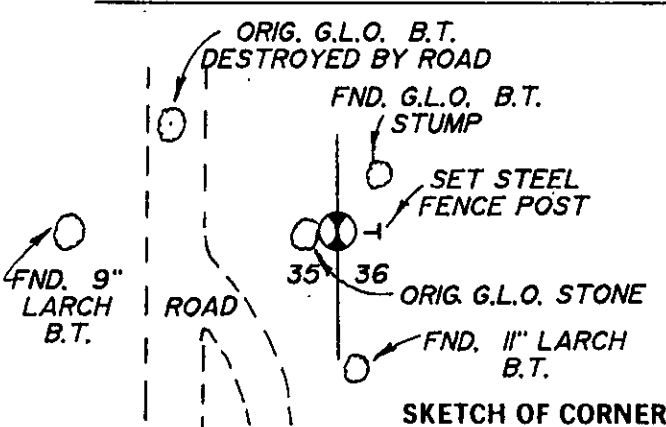

CERTIFICATION

I, Daniel P. Brien
certify the information shown herein is true and correct.

Signature Ground Party Chief
Daniel P. Brien

I, Daniel P. Brien
certify that this Corner Record correctly represents work performed by me or under my direction in compliance with the "Corner Recordation Act" (70-22-101, et seq., M.C.A.)

Signature of Surveyor & Seal
Daniel P. Brien

Date: 1/26/93 Reg. No. 7681 S
Employer: HERSMAN LAND SURVEY

Office of Clerk and Recorder, County of Lincoln. This "corner record" was filed for record on Feb 3, 1993 was noted on the cross-index plat and is assigned page No. 5334, in book No. _____

Carol M. Cummings County Official

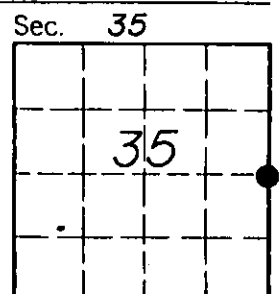

Cross Index No. X 21 T. 36N. R. 26W. P.M.M.

• - corner this sheet