

## CERTIFIED LAND CORNER RECORDATION --

## DESCRIPTION OF CORNER EVIDENCE FOUND, AND ORIGINAL RECORD (IF KNOWN)

ORIGINAL G.L.O. NOTES: "Set a limestone, 15 X 12 X 8 ins. 10. ins. in the ground, for Cor. to Secs. 7. 12 13 & 18 marked with 2 notches on N and 4 notches on S edges. dug pits 18X18X12 ins. in each Sec. 5 1-2 ft. dist. and raised a mound of earth 2 ft. high, 4 1-2 ft. base alongside."

FOUND:

NO ORIGINAL EVIDENCE FOUND

## DESCRIPTION OF MONUMENT AND ACCESSORIES ESTABLISHED TO PERPETUATE THE ORIGINAL LOCATION OF THIS CORNER:

This corner was set at a point of intersection between two existing corners and an East West fence.

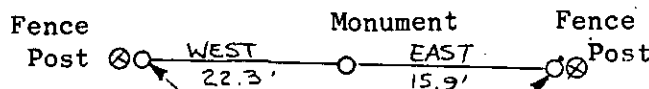

5/8" RE-BAR WITH  
ALU, CAP MARKED  
"HAIGES 2520S R.P."

Date of work: JUNE 1977

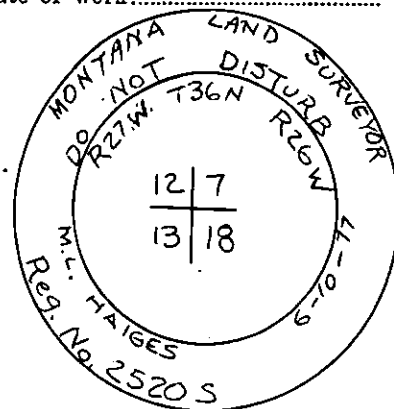

SKETCH, WITH COURSE AND DISTANCE TO ADJACENT CORNERS IF DETERMINED IN THIS SURVEY.  
(MAY SKETCH OR PASTE REPRODUCTION ON REVERSE SIDE.)

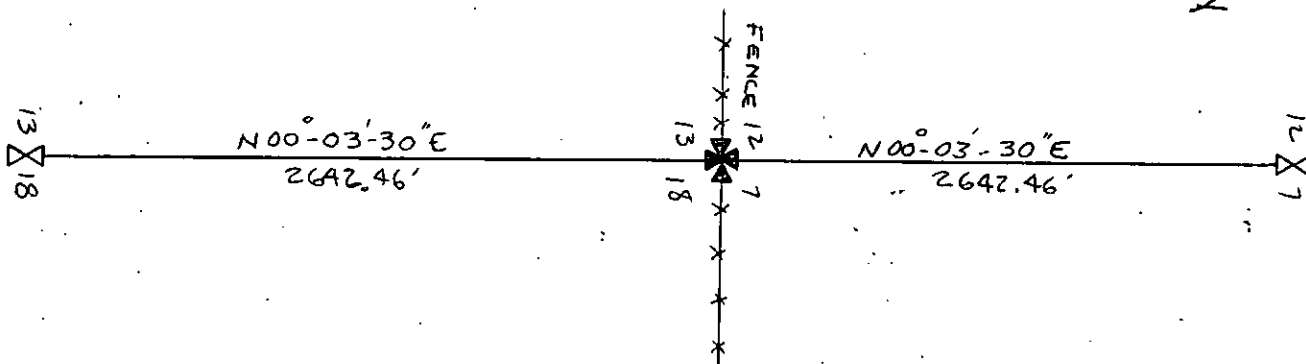

Surveyor's Seal

I, JAMES BURTON  
certify that the information shown herein is true and correct.

*James Burton*  
Signature of Ground Party Chief

I, M. L. HAIGES  
certify that I have carefully performed or reviewed the work done on the diagrammed corner as reported on this recordation form and approve the same.

*M. L. Haiges*  
Signature of Surveyor

DIAGRAM OF CORNER:  
R27N T36N R26W

N.

12 7  
13 18

N.W. SEC. COR. SEC. 18

X = Corner recorded on the sheet

2520 S

Registration Number

Office of Clerk and Recorder, County of Lincoln

This "corner record" was filed for record on the 13<sup>th</sup> day of April, 1978, was noted on the cross-index plat and is

signed page No. 520, in book No. 1

*Eleanor L. Daugherty*  
County Official  
*Betty Bell*  
Deputy