

## INSTRUCTIONS

1. Original and/or subsequent record used to evaluate the corner position.
2. Description of evidence found, note discrepancies in the record, state method of establishing lost or obliterated corners.
3. Description of monument and accessories set to perpetuate the corner position.
4. Sketch of corner, show all pertinent data which can best be shown in a sketch example, corner marking, topography ties, position of accessories, etc.
5. Certification must be signed and sealed by Land Surveyor registered in the State of Montana.
6. Fill in Cross Index & Section Diagram at bottom of sheet.

## CERTIFIED CORNER RECORDATION

Corner South 1/4 Sec. 10 T. 36 N R. 26 W P.M.M. Lincoln County

- I. 1893 G.L.O. original record by P. Mc Cardell & A. Jaqueth et al: Set a wooden post and mkd. 1/4S on the North face. and mkd 2 bearing trees.

1960 BLM remonumentation record by D. Cunningham & W. Stephens et al: " The 1/4 sec. cor. of secs. 10 and 15, monumented with a disintegrated wooden post, firmly set in the ground, and witnessed by one of the original bearing trees. At the corner point, set an iron post, 30 ins. long, 2 1/2 ins. diam., 28 ins. in the ground, in concrete, with brass cap mkd. "

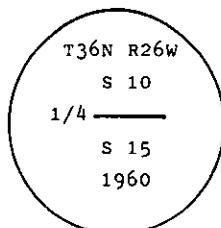

from which

The original bearing tree:

A fir, 18 ins. diam., bears  $S72\frac{1}{2}^{\circ}E$ , 37 lks. dist., mkd. 1/4 S BT. ( record )

The new bearing tree:

A fir, 10 ins. diam., bears  $N54^{\circ}E$ , 28 lks. dist., mkd. 1/4 S10 BT.

Raise a mound of stone, 3 ft. base, 2 ft. high, N. of the iron post.

- II. Found a firmly set 3 1/4 in. diam. BLM brass cap marked as shown, with a rock mound north of the cor., from which

A fir, 18 ins. dia., bears  $S72^{\circ}30'E$ , 23.4 ft. dist., scribing overgrown (original).

A fir, 17 ins. dia., bears  $N54^{\circ}E$ , 18.48 ft. dist., scribing overgrown (BLM).

- III. Painted red bands around the bearing trees and attached Land Survey Monument and Bearing Tree signs.  
Set a 6 ft. galvanized steel guard post with Land Survey Marker and Property Boundary decals, North, 5 ft.  
Magnetic Declination:  $20^{\circ}30'$  East

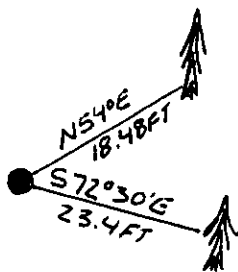

SKETCH OF CORNER

## CERTIFICATION

I, Kenneth R. Kern  
certify the information shown herein is true and correct.

Kenneth Kern  
Signature Ground Party Chief

I, Alvah F. Hughes  
certify that this Corner Record correctly represents work performed by me or under my direction in compliance with the Montana Corner Recordation Act (70-22-101, et seq., M.C.A.).

Alvah F. Hughes  
Signature of Surveyor & Seal

Date: 4/10/92 Reg. No. 7322ES

Employer: U.S. FOREST SERVICE

Sec. 10

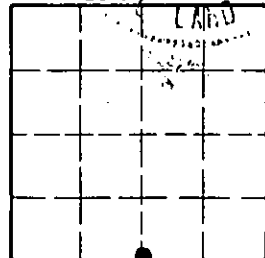

Office of Clerk and Recorder, County of Lincoln. This "corner record" was filed for record on 5-4-92 was noted on the cross-index plat and is assigned page No. 5078, in book No. Coral M. Cunningham

County Official

J-15

36 N 26 W

Cross Index No. T. R. PMM

• - corner this sheet