

# CERTIFIED LAND CORNER RECORDATION

## DESCRIPTION OF CORNER EVIDENCE FOUND, AND ORIGINAL RECORD (IF KNOWN)

G.L.O. Record: Set a Post marked "1/4S" on North face from which:  
 A 14" Fir bears N 1°15' W 59 links  
 A 9" Tamarack bears S 34°30' E 15 links

Found: A squared post (not G.L.O.) on old fenceline, original G.L.O. post with scribing still visible lying on ground at base. An old Fir stump, badly rotted, bears N 5°W 40.3', an old Tamarack stump with destroyed face bears S 18° E 9.6'. Set brass cap at base of post described above.

## DESCRIPTION OF MONUMENT AND ACCESSORIES ESTABLISHED TO PERPETUATE THE ORIGINAL LOCATION OF THIS CORNER:

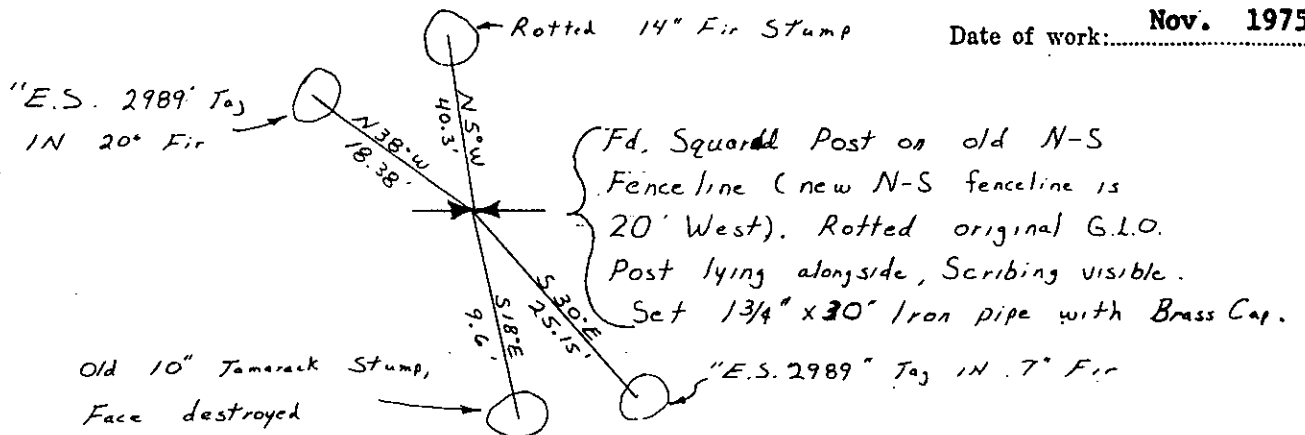

SKETCH, WITH COURSE AND DISTANCE TO ADJACENT CORNERS IF DETERMINED IN THIS SURVEY. (MAY SKETCH OR PASTE REPRODUCTION ON REVERSE SIDE.)

See Certificate of Survey Number 152

Surveyor's Seal

S. R. Smith

I, \_\_\_\_\_  
 certify that the information shown herein is true and correct.

*S. R. Smith*

Signature of Ground Party Chief

I, Dean K. Marquardt  
 certify that I have carefully performed or reviewed the work done on the diagrammed corner as reported on this recordation form and approve the same.

*Dean K. Marquardt*

Signature of Surveyor

DIAGRAM OF CORNER:

N. T 36 N  
 S 29 1/4 S 32  
 R 26 W

ES2989

Registration Number

Office of Clerk and Recorder, County of Lincoln  
 This "corner record" was filed for record on the 28th day of January, 1976, was noted on the cross-index plat and is assigned page No. 419, in book No. 1

*Charles Hugh Mc Watson*  
 County Official