

CERTIFIED LAND CORNER RECORDATION

DESCRIPTION OF CORNER EVIDENCE FOUND, AND ORIGINAL RECORD (IF KNOWN)

Original Record: Post 3' long x 3" square from which
 Pine 32" bears N. 87° 30' W. 103 lks.
 Pine 36" bears S. 83° W. 299 lks.

DESCRIPTION OF MONUMENT AND ACCESSORIES ESTABLISHED TO PERPETUATE THE ORIGINAL LOCATION OF THIS CORNER:

Date of work May, 1975

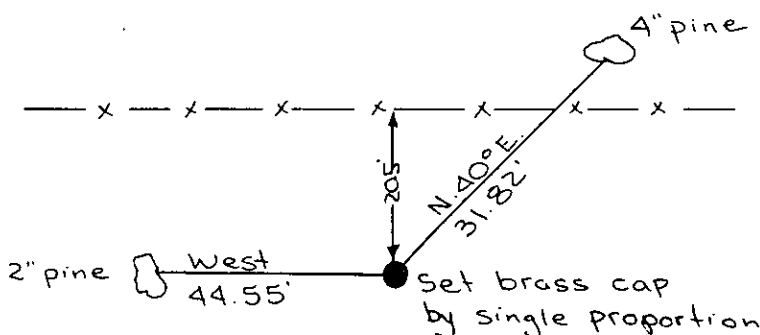

SKETCH, WITH COURSE AND DISTANCE TO ADJACENT CORNERS IF DETERMINED IN THIS SURVEY. (MAY SKETCH OR PASTE REPRODUCTION ON REVERSE SIDE.)

See Certificate of Survey # 152

Surveyor's Seal

I, _____
 certify that the information shown herein is true and correct.

 Signature of Ground Party Chief

I, Dean K. Marquardt
 certify that I have carefully performed or reviewed the work done on the diagrammed corner as reported on this recordation form and approve the same.

Dean K. Marquardt
 Signature of Surveyor

DIAGRAM OF CORNER:

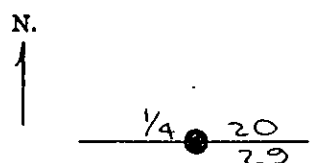

● = Corner recorded on the sheet

ES2989
 Registration Number

Office of Clerk and Recorder, County of Lincoln

This "corner record" was filed for record on the 28th day of January, 1976, was noted on the cross-index plat and is

assigned page No. 416, in book No. 1

Clarence L. Laughon, Mae Watson, Deputy
 County Official