

# CERTIFIED LAND CORNER RECORDATION

## DESCRIPTION OF CORNER EVIDENCE FOUND, AND ORIGINAL RECORD (IF KNOWN)

Original Record: Post 4' long x 4" square from which  
 Pine 40" bears N. 66° E. 129 lks.  
 Pine 32" bears S. 59° 30' E. 140 lks.  
 Pine 40" bears S. 71° W. 82 lks.  
 Pine 36" bears N. 60° W. 125 lks

## DESCRIPTION OF MONUMENT AND ACCESSORIES ESTABLISHED TO PERPETUATE THE ORIGINAL LOCATION OF THIS CORNER:

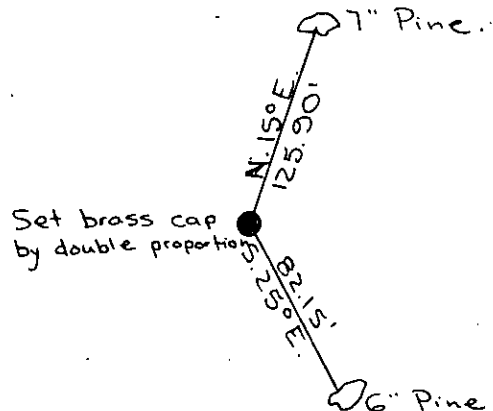

Date of work: May, 1975

## SKETCH, WITH COURSE AND DISTANCE TO ADJACENT CORNERS IF DETERMINED IN THIS SURVEY. (MAY SKETCH OR PASTE REPRODUCTION ON REVERSE SIDE.)

See Certificate of Survey # 152

Surveyor's Seal

I, \_\_\_\_\_  
 certify that the information shown herein is true and  
 correct.

\_\_\_\_\_  
 Signature of Ground Party Chief

I, Dean K. Marquardt  
 certify that I have carefully performed or reviewed the  
 work done on the diagrammed corner as reported on this  
 recordation form and approve the same.

Dean K. Marquardt  
 Signature of Surveyor

## DIAGRAM OF CORNER:

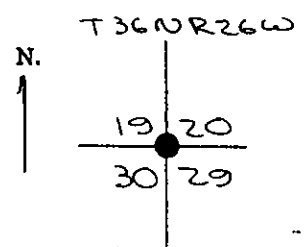

● = Corner recorded on the sheet

ES2989  
 Registration Number

Office of Clerk and Recorder, County of Lincoln  
 This "corner record" was filed for record on the 28th day of January, 1976, was noted on the cross-index plat and is  
 assigned page No. H 15, in book No. 1

Charles L. Vaughn, Mae Watson, Deputy  
 County Official