

# CERTIFIED LAND CORNER RECORDATION

## DESCRIPTION OF CORNER EVIDENCE FOUND, AND ORIGINAL RECORD (IF KNOWN)

G.L.O. Record: Set Post marked "1/4" on North face, from which:  
 A fir 6" diam. bears N 32°30' E 23 links  
 A pine 8" diam. bears S 32°30' W 44 links

Found: Stone marked 1/4S on North face (record calls for post), NE bearing tree.

## DESCRIPTION OF MONUMENT AND ACCESSORIES ESTABLISHED TO PERPETUATE THE ORIGINAL LOCATION OF THIS CORNER:

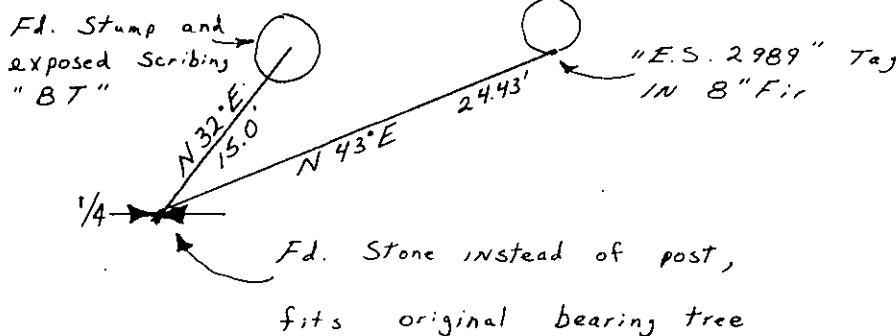

Date of work: Nov. 1975

## SKETCH, WITH COURSE AND DISTANCE TO ADJACENT CORNERS IF DETERMINED IN THIS SURVEY. (MAY SKETCH OR PASTE REPRODUCTION ON REVERSE SIDE.)

See Certificate of Survey Number 152

Surveyor's Seal

S. R. Smith

I, \_\_\_\_\_  
 certify that the information shown herein is true and correct.

*S. R. Smith*

Signature of Ground Party Chief

I, Dean K. Marquardt  
 certify that I have carefully performed or reviewed the work done on the diagrammed corner as reported on this recordation form and approve the same.

*Dean K. Marquardt*  
 Signature of Surveyor

## DIAGRAM OF CORNER:

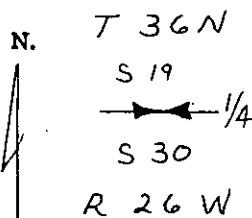

= Corner recorded on the sheet

ES2989  
 Registration Number

Office of Clerk and Recorder, County of Lincoln

This "corner record" was filed for record on the 28<sup>th</sup> day of January 1976, was noted on the cross-index plat and is

assigned page No. 414, in book No. 1

*Charles L. Vaughn*  
 County Official