

INSTRUCTIONS

1. Original and/or subsequent record used to evaluate the corner position.
2. Description of evidence found, note discrepancies in the record, state method of establishing lost or obliterated corners.
3. Description of monument and accessories set to perpetuate the corner position.
4. Sketch or corner, show all pertinent data which can best be shown in a sketch example, corner marking, topography ties, position of accessories, etc.
5. Certification must be signed and sealed by Registered Land Surveyor in State of Montana.
6. Fill in Cross Index & Section Diagram at bottom of sheet.

CERTIFIED CORNER RECORDATION

Corner CS 1/16 Sec. 23 T. 36N R. 26W P.M.M. Lincoln County

RECORD: None available

FOUND: A 1.5 foot high 2" diameter iron pipe bears south, 25.2 feet from set cap.

SET: A 2½" x 30" Forest Service aluminum pipe approximately 26" in ground with an aluminum cap marked as shown, surrounded with a stone collar.

FROM WHICH:

A 5" fir bears S82E, 15.9 feet, inscribed XBT.

A 13" fir bears S28E, 26.4 feet, inscribed CS 1/16 BT.

A location poster bears S08W, 17.6 feet.

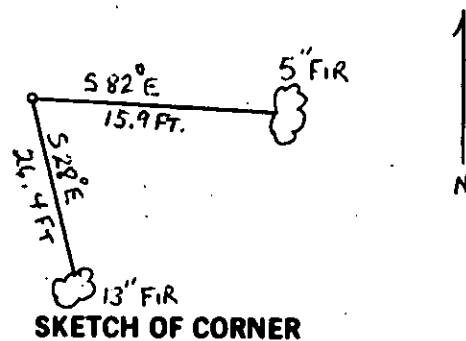
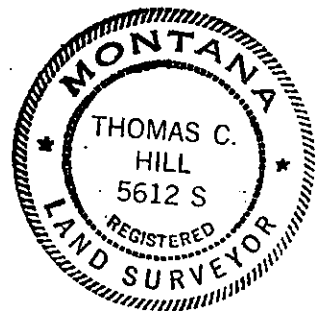
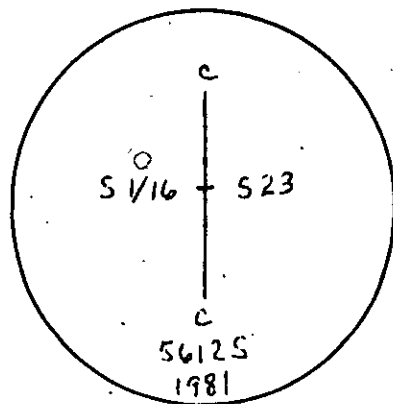

CERTIFICATION

I, JAMES W. REED
certify the information shown herein is true and correct.

James W. Reed
Signature Ground Party Chief

I, _____
certify that this Corner Record correctly represents work performed by me or under my direction in compliance with the "Corner Recordation Act" (70-22-101, et seq., M.D.A.)

Thomas C. Hill
Signature of Surveyor & Seal

Date: 1-27-82 Reg. No. 5612-S

Employer: USFS

Office of Clerk and Recorder, County of Lincoln. This "corner record" was filed for record on the March 16 day of 1982 was noted on the cross-index plat and is assigned page No. 1434, in book No. 1

Eleanor L. Vaughn by Betty L. Conner
County Official Deputy

Cross Index No. Q-19 T. 36N R. 26W PMM

Sec. 23

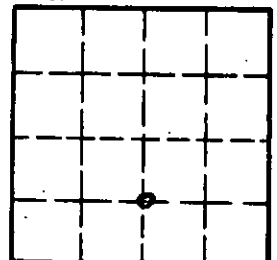

• corner this sheet