

INSTRUCTIONS

1. Original and/or subsequent record used to evaluate the corner position.
2. Description of evidence found, note discrepancies in the record, state method of establishing lost or obliterated corners.
3. Description of monument and accessories set to perpetuate the corner position.
4. Sketch or corner, show all pertinent data which can best be shown in a sketch example, corner marking, topography ties, position of accessories, etc.
5. Certification must be signed and sealed by Registered Land Surveyor in State of Montana.
6. Fill in Cross Index & Section Diagram at bottom of sheet.

CERTIFIED CORNER RECORDATION

Corner S 1/16 Sec. 23 | 24 T. 36N R. 26W P.M.M. Lincoln County

RECORD: None available

FOUND: A 1" diameter iron pipe, bears N16E, 6.3 feet from set cap.

SET: A 2½" x 30" aluminum forest service pipe approximately 26" in ground with an aluminum cap marked as shown, surrounded with a stone collar.

FROM WHICH:

A 9" pine bears N40E, 11.7 feet, inscribed XBT,

A 9" pine bears N76W, 22.6 feet, inscribed S23 BT.

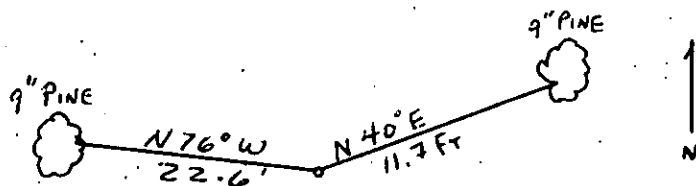
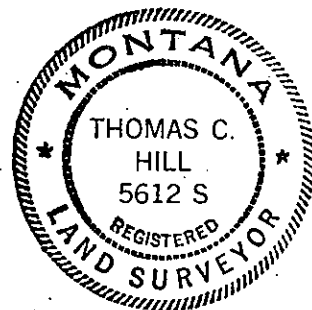
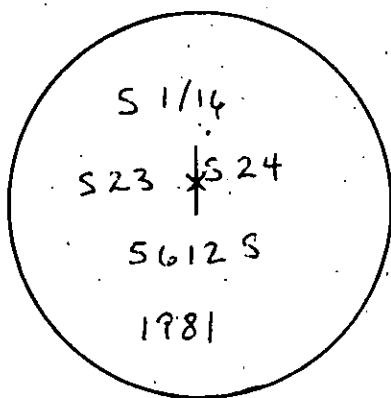

SKETCH OF CORNER

CERTIFICATION

1. JAMES W REED
certify the information shown herein is true and correct.

James W Reed
Signature Ground Party Chief

2. I certify that this Corner Record correctly represents work performed by me or under my direction in compliance with the "Corner Recordation Act" (79-23-101, et seq., M.D.A.)

Thomas C Hill
Signature of Surveyor & Seal

Date: 1-27-82 Reg. No. 5612-S

Employer: USFS

Office of Clerk and Recorder, County of LINCOLN. This "corner record" was filed for record on the MARCH 16 day of 1982 was noted on the cross-index plat and is assigned page No. 1632, in book No. 1

Eleanor L. Laughlin by Betty L. Conces
County Official deputy

Cross Index No. Q-21 T. 36N R. 26W P.M.M.

Sec. 23

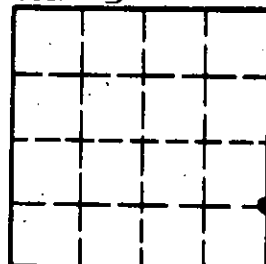

• - corner this sheet