

INSTRUCTIONS

1. Original and/or subsequent record used to evaluate the corner position.
2. Description of evidence found, note discrepancies in the record, state method of establishing lost or obliterated corners.
3. Description of monument and accessories set to perpetuate the corner position.
4. Sketch of corner, show all pertinent data which can best be shown in a sketch example, corner marking, topography ties, position of accessories, etc.
5. Certification must be signed and sealed by Registered Land Surveyor in State of Montana.
6. Fill in Cross Index & Section Diagram at bottom of sheet.

CERTIFIED CORNER RECORDATION

Corner $\frac{1}{4}$ corner: $\frac{S}{S} \frac{11}{14}$ T. 36N R. 26W P.M.M. Lincoln County

RECORD:

GLO: Set quartzite boulder 16x14x12", 11" in ground for $\frac{1}{4}$ Sec. Cor., marked $\frac{1}{4}$ on N. face.

FROM WHICH:

A pine 9" diam. bears N. 20° 30' W. 65 LKS. Dist., marked $\frac{1}{4}$ S.B.T.
A fir 8" diam. bears S. 13° E., 14 LKS. Dist., marked $\frac{1}{4}$ S.B.T.

FOUND: The position of this corner fell in a clearcut area. Approximately 3/4 of one crew day was spent searching for evidence of this corner, no evidence was found and the corner was determined lost.

SET: By single proportion a 2½" x 30" Forest Service aluminum pipe approximately 24" in ground with an aluminum cap marked as shown with a stone collar.

FROM WHICH:

A 4" fir bears S28W, 56.4 feet, inscribed S 14 BT.
A 2" pine bears N64E, 51.7 feet, inscribed S 11 BT.

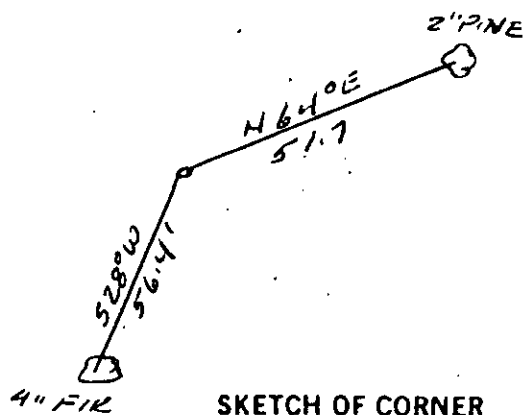
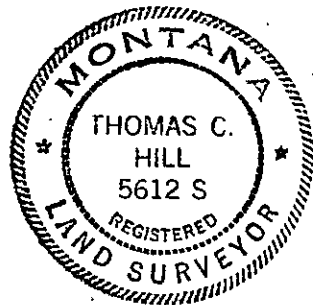
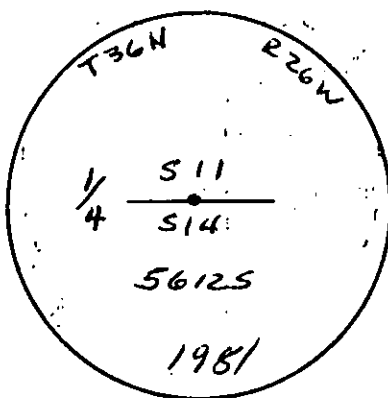

SKETCH OF CORNER

CERTIFICATION

1. JAMES W. REED

certify the information shown herein is true and correct.

James W. Reed
Signature Ground Party Chief

2. certify that this Corner Record correctly represents work performed by me or under my direction in compliance with the "Corner Recordation Act" (70-22-101, et seq., M.D.A.)

Thomas C. Hill
Signature of Surveyor & Seal

Date: 2-16-82 Reg. No. 5612-S

Employer: USFS

Office of Clerk and Recorder, County of Lincoln. This "corner record" was filed for record on the March 16th day of 1982, was noted on the cross-index plat and is assigned page No. 16002, in book No. 1

Eleanor S. Laughlin by Betty L. Conces
County Official deputy

Cross Index No. J-19 T. 36N R. 26W P.M.M.

Sec. 11

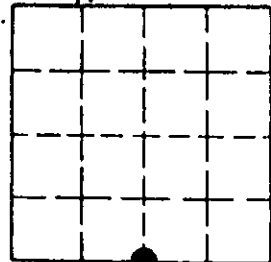

• corner this sheet