

CERTIFIED CORNER RECORDATION

Corner WC CC 2 ES 1252 T. 36 N. R. 26 W. P.M.M. LINCOLN County

- I. Record: 1893 Subdivision and Meanders of T36N. R26W. by Peter M. Cardell and Abraham L. Jaqueth:
1933 U. S. Forest Service Exchange Survey No. 1252 by A. O. Modlin: Point at top of steep, sliding bank, which I establish for W. C. to cor. No. 2 and closing cor. of this survey as follows:

Place a small stone marked with a cross (X) under granite stone 26x14x12 ins., 16 ins. in the ground, marked W C C C 2 E S 1252 on the SE. face, and a cross (X) on top for the exact cor. point, from which

A cross (X) on a Douglas fir 18 ins. dia. bears S11°35'W 22 lks. dist. marked W C C C 2 E S 1252 BT.

A cross (X) on a Douglas fir 26 ins. dia. bears S47°10'W 23 lks. dist., marked W C C C 2 E S 1252 BT.

Raise a mound of earth 4 ft. base, 2 ft. high. SE. of corner.

- II. Found a stone 11x15 ins., 12 ins. above ground, firmly set and clearly marked W C C C 2 ES 1252 on SE face and an "X" on top, from which:

A fir, 13 ins. diam, bears S12°W, 15.2 ft. dist., mkd. with a healed face. (Rec. 14.5 ft.)

A fir, 24 ins. diam, bears S47°W, 16.5 ft. dist., mkd. W C C C 2 ES 1252 BT. (Rec. 15.2 ft.)

- III. Painted red the scribed face and a red band around the bearing trees.

Date of Fieldwork: 10/20/2006

Survey crew: Tom Hommel

Magnetic declination: 20° East assumed

Equipment used: Hand compass and loggers tape

U.S. Forest Service, Supervisors Office, 1101 Hwy. 2 West, Libby, MT 59923 (406) 293-6211

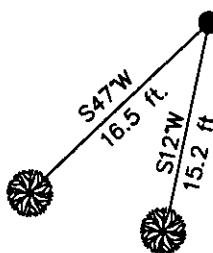

SKETCH OF CORNER

NOT TO SCALE

CERTIFICATION

I, Thomas M. Hommel 10800LS
certify the information shown herein is true and correct.

Thomas M. Hommel
Signature of Ground Party Chief

I, Steven A. Boyer
certify that this Corner Record correctly represents work performed by me or under my direction in compliance with the "Corner Recordation Act" (70-22-101, et seq., M.C.A.)

Steven A. Boyer
Signature of Surveyor & Seal

Date: 11/01/2006 Reg. No. 9750LS

Employer: U. S. Forest Service

Sec. 30

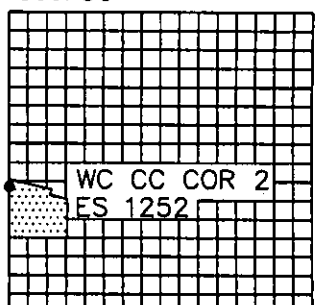

• corner this sheet

Office of Clerk and Recorder, County of Lincoln This "corner

record" was filed for 199644 BOOK: CCR CC&R'S PAGE: 10978 Pages: 1

was noted on the cr STATE OF MONTANA LINCOLN COUNTY
RECORDED: 12/13/2006 12:58 KOI: CC&R'S

book No. CORAL M. CUMMINGS CLERK AND RECORDER

FEE: \$0.00

BY: Garnie Derrin

TO: US FOREST SERVICE

Cross Index No. WC CC 5 ES 1252 T. 36N. R. 26W. P.M., MT

Adopted July 1, 1981, Montana Board of Professional Engineers & Land Surveyors