

CERTIFIED CORNER RECORDATION

Corner C 1/4 S28 T 36 N. R. 26 W. P.M.M. LINCOLN County

I. Record: No previous record.

II. Found: No evidence found.

III. Perpetuation: At the calculated position, determined by a section subdivision survey, set a 5/8 in. diam. rebar, 24 ins. long, 22 ins. in the ground with a 3 1/4 in. diam. standard U.S.D.A alum. cap mkd. as shown below, from which:

A fir, 15 ins. diam., bears N11°W., 11.00 ft. dist., mkd. C1/4 S28 BT.

A fir, 16 ins. diam., bears N.68°W., 44.60 ft. dist., mkd. C1/4 S28 BT.

Painted faces and 6 in. wide red bands to all bearing trees and attached Land Survey Monument and Bearing Tree signs.

Set a steel post with attached property boundary sticker 3 ft. S. on line.

Magnetic declination: 20° East

Equipment used: Hand compass and loggers tape

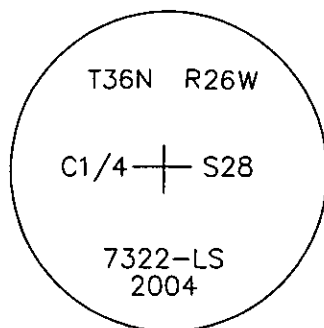

Kootenai Surveyors Inc., 314 California Av., Libby, MT. 59923 (406) 293-4354

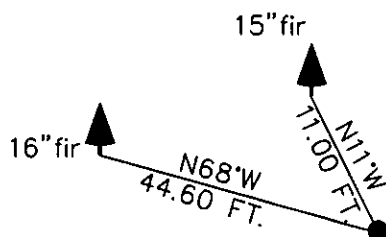

SKETCH OF CORNER

CERTIFICATION

I, Doug Schuhknecht
certify the information shown herein is true and correct.

Signature Ground Party Chief

Alvah F. Hughes

I certify that this Corner Record correctly represents the corner as performed by me or under my direction in compliance with the "Corner Recordation Act" (MCA) 10-22-101.

Signature of Surveyor & Seal

Date: 06/21/2004 Reg. No. 7322-LS

Employer: Kootenai Surveyors Inc.

Office of C 180693 BOOK: CCR CC&R'S PAGE: 10702 Pages: 1
record" wa STATE OF MONTANA LINCOLN COUNTY
was noted RECORDED: 11/16/2004 1:15 KOI: CC&R'S
book No. CORAL M. CUMMINGS CLERK AND RECORDER
FEE: \$0.00
TO: FILED BY: Leanne Davis in
County Official

10702

Cross Index No. T 11 T. 36N. R. 26W. P.M., MT

Adopted July 1, 1981, Montana Board of Professional Engineers & Land Surveyors

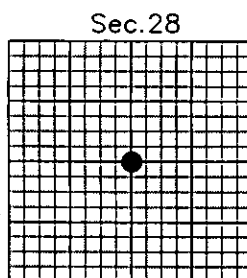

• corner this sheet