

## INSTRUCTIONS

1. Original and/or subsequent record used to evaluate the corner position.
2. Description of evidence found, note discrepancies in the record, state method of establishing lost or obliterated corners.
3. Description of monument and accessories set to perpetuate the corner position.
4. Sketch of corner, show all pertinent data which can best be shown in a sketch example, corner marking, topography ties, position of accessories, etc.
5. Certification must be signed and sealed by Land Surveyor registered in the State of Montana.
6. Fill in Cross Index & Section Diagram at bottom of sheet.

## CERTIFIED CORNER RECORDATION

Corner 2 of HES 784 T. 36 N. R. 25 W. P.M.M. Lincoln County

- I. 1917 H.E.S. original record by R. E. Maurer: " Cor. No. 2 identical with Cor. No. 2 of the listing survey a shale stone, 4x8x6 ins. above ground, marked H/2 and witnessed by one bearing tree. I destroy the list corner and accessories and set for Cor. No. 2, a small stone, mkd with a cross (X) under a slate stone, 28 X 10 X 7 ins., 18 ins. in the ground, marked 2 HES 784 on the SE. face and a cross (X) on top for the exact corner point.

From which: " Two bearing trees. A mound of stone 4 ft. base, 2 ft. high, SE. of corner.

1960 B.L.M. Resurvey by D. Cunningham: " Cor. No. 2 of H.E.S. No. 784, monumented with a shale stone, 26x10x7 ins., set and marked as described in the official record, and witnessed by the remains of the original bearing trees. At corner point set an iron post, 30 ins. long, 2 1/2 ins. diam., 26 ins. in the ground, in concrete, with brass cap mkd.:

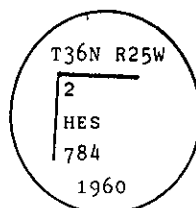

from which

The original bearing trees:

A stump hole, bears S 70° 01' E., 34 lks. dist., with fallen log mkd. X. (Record)

A fir stump, 8 ins. diam., bears N. 22-1/2° W., 25 lks. dist., mkd. 2 HES 784 BT.

(Record: N. 23° 56' W., 25 lks. dist.)

The new bearing trees:

A birch, 6 ins. diam., bears S. 69-1/2° E., 35 lks. dist., mkd. 2 HES 784 BT.

A fir, 14 ins. diam., bears S. 89-1/2° W., 96 lks. dist., mkd. 2 HES 784 BT.

Bury the original stone alongside and raise a mound of stone, 3 ft. base, 2 ft. high, SE. of the iron post."

- II. Found a BLM brass cap 3 1/4 ins. diam., flush with the ground with a rock mound 2 ft. East of corner. Brass cap marked as shown above.

From which:

A birch, 9 ins. diam, bears S68° E., 22.7 ft. (34.4 lks.) dist., mkd. 2 HES 784 BT.

(1960: S69-1/2° E., 35 lks. dist.)

A douglas fir, bears N89° W., 63.7 ft. (96.5 lks.) dist., healed face.

(1960: S 89-1/2° W., 96 lks. dist.)

A rotten fir stump bears N18° W., 13.7 ft. (20.8 lks.) dist., mkd. 2 HES 784 BT. (Original)

- III. Establish:

Painted red bands around the bearing trees and attached "Land Survey Monument" and "Bearing Tree" signs.

Set a 6 ft. galvanized steel guard post with "Land Survey Marker" and "Property Boundary" decals, South, 3 ft. dist from corner.

Magnetic declination: 20° East

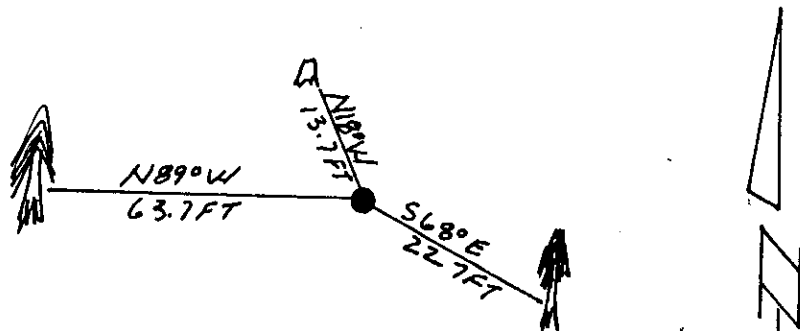

SKETCH OF CORNER

## CERTIFICATION

Tom Hommel

I, Tom Hommel certify the information shown herein is true and correct.

Signature Ground Party Chief

Alvah F. Hughes

I, Alvah F. Hughes certify that this Corner Record correctly represents work performed by me or under my direction in compliance with the "Corner Recordation Act" (70-22-101, et seq., M.C.A.)

Signature of Surveyor & Seal

Date: 11/26/91 Reg. No. 7322-LSA

Employer: U.S. FOREST SERVICE

Office of Clerk and Recorder, County of Lincoln. This "corner record" was filed for record on 4-21-92

was noted on the cross-index plat and is assigned page No. 5003, in book No. Coral M. Cummings

County Official

2 HES 784

36 N 25 W

Cross Index No. \_\_\_\_\_ T. \_\_\_\_\_ R. \_\_\_\_\_ PMM

Sec. 34

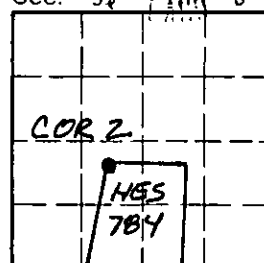

• - corner this sheet