

CERTIFIED CORNER RECORDATION

Corner North MC Secs. 17&18 T. 35N R. 26W P.M., MT Lincoln County

- I. 1894 G.L.O. Original record by Abram L. Jaqueth: Set a quartzite stone, 12x12x8 ins., 8 ins. the ground, for meander cor. to frac. secs. 17 & 18, mkd. "MC" on the S. face.

From which:

A larch, 14 ins. diam., bears N39°E, 68 lks. dist., mkd. "T35N R26W S17 MC BT".
A fir, 16 ins. diam., bears N74°15'W, 68 lks. dist., mkd. "T35N R26W S18 MC BT".

1959 B.L.M. record by David R. Cunningham: The meander cor. of secs. 17 and 18, on the N. shore of Frank's Lake, determined at record bearing and dist. from the orig. N.E. bearing tree, which is a snag. At the corner point, set an iron post, 30 ins. long, 2 1/2 ins. diam., 26 ins. in the ground, in concrete, with brass cap mkd. as shown:

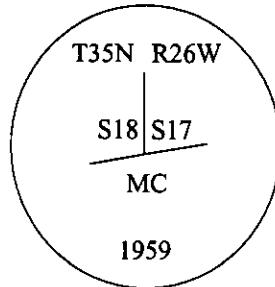

Established two new bearing trees:

A fir, 6 ins. diam., bears S62 3/4°E, 5 lks. dist., mkd. "T35N R26W S17 MC BT".
A fir, 6 ins. diam., bears N13°W, 14 lks. dist., mkd. "T35N R26W S18 MC BT".

Raise a mound of stone, 3 ft. base, 2 ft. high, N. of the iron post.

- II. Found a 2 1/2 in. diam., iron post, firmly set, protruding 5 ins. above the ground, with a 3 1/4 in. diam. BLM brass cap mkd. as shown above.

From which:

A stump with downed log alongside, bears S62°E, 3.3 ft. (5 lks.) dist., mkd. with visible scribe.
A fir, 9 ins. diam., bears N13°W, 9.9 ft. (15 lks.) dist., mkd. with a healed face.
No evidence of orig. bearing trees found.
A steel guard post, bears East, 1.0 ft. dist., with LSM decal.

- III. Established one new bearing tree:
A fir, 10 ins. diam., bears N58°W, 10.2 ft. dist., mkd. "MC S18 BT".

Painted bearing trees and attached Land Survey Monument and Bearing Tree signs.

Magnetic Declination: 20° East.

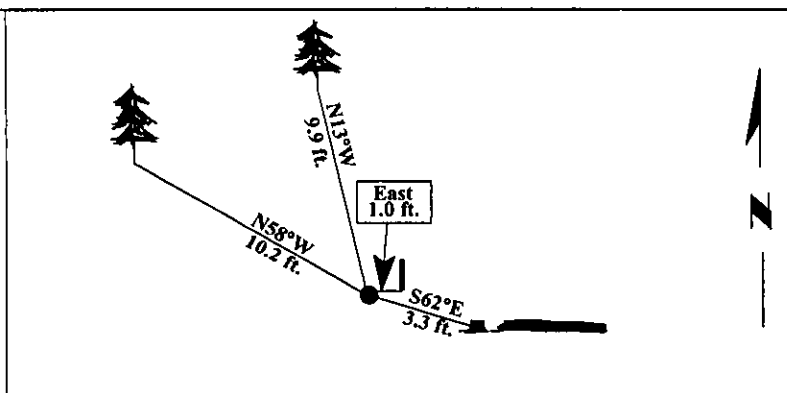

SKETCH OF CORNER

CERTIFICATION

I, Mark Federman

certify the information shown herein is true and correct.

Mark Federman

I, Alvah F. Hughes

certify that this Corner Record correctly represents work performed by me or under my direction in compliance with the "Corner Recordation Act" (70-22107, et seq., M.C.A.)

Alvah F. Hughes
Signature of Surveyor & Seal

Date: 12/26/96

Reg. No.: 7322LS

Employer: U.S. FOREST SERVICE

Sec. 17

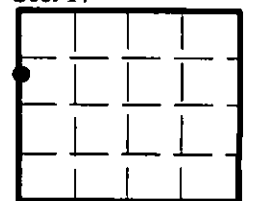

• - corner this sheet

Office of Clerk and Recorder, County of LINCOLN. This "corner record" was filed for record on FEB 3, 1997 and was noted on the cross-index plat and is assigned page No. 9213, in book No. CORAL M. CUMMINGS By JFB

County Official

Cross Index No. K.25-5 T. 35N R. 26W P.M., MT

