

CERTIFIED CORNER RECORDATION

Corner 1/4 Sec. 28 & 29 T. 35N R. 26W P.M., MT Lincoln County

- I. 1894 G.L.O. Original record by Abram L. Jaqueth: Set a wooden post, 3 ft. long, 3 ins. square, 24 ins. in the ground, for 1/4 Sec. Cor., mkd. 1/4 S. on the W. face.

From which:

A larch, 12 ins. diam., bears S72° 45'E, 36 lks. dist., scribed "1/4 S BT".
A larch, 13 ins. diam., bears S3° 15'W, 33 lks. dist., scribed "1/4 S BT".

1973 CCR by Dean K. Marquardt, filed at Lincoln County Courthouse, Book #1, page #1137: Found two original B.T. stumps with scribing still visible. Found evidence of original post. Set a brass cap mkd. as shown below:

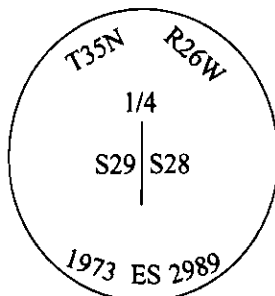

Established two new bearing trees:

A tree with "ES Tag", bears S59°E, 22.7 ft. dist..
A tree with "ES Tag", bears S10°W, 28.2 ft. dist..

- II. Found a 2 in. diam. brass cap, firmly set, flush with ground, with cap mkd. as shown above.

From which:

A fir, 14 ins. diam., bears S32°E, 15.6 ft. dist., with "ES Tag".
A fir, 18 ins. diam., bears West, 9.1 ft. dist., with "ES Tag".
(The bearing trees were not scribed, and neither matches Marquardt record.)
A 6 ft. tall, 6.5 in. x 9 in. square, wooden post, bears East, 1.5 ft. from monument.
No evidence of orig. bearing trees found.

- III. Scribed and painted existing bearing trees and attached Land Survey Monument and Bearing Tree signs.

A fir, 14 ins. diam., bears S32°E, 15.6 ft. dist., scribed "1/4 S28 BT".
A fir, 18 ins. diam., bears West, 9.1 ft. dist., scribed "1/4 S29 BT".

Magnetic Declination: 20° East.

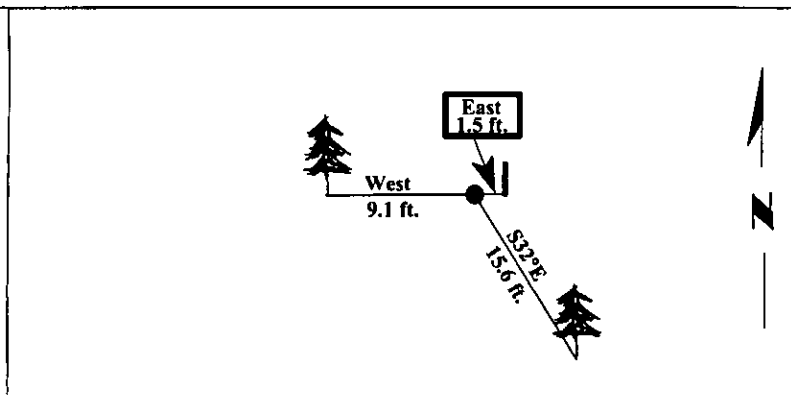

SKETCH OF CORNER

CERTIFICATION	
I, <u>Mark Federman</u>	certify the information shown herein is true and correct.
<i>Mark Federman</i>	
I, <u>Alvah F. Hughes</u>	certify that this Corner Record correctly represents work performed by me or under my direction in compliance with the "Corner Recordation Act" (70-22-101, et seq., M.C.A.)
<i>Alvah F. Hughes</i>	
Date: <u>12/26/96</u>	Signature of Surveyor or Seal
Reg. No.: <u>7322LS</u>	
Employer: <u>U.S. FOREST SERVICE</u>	

Office of Clerk and Recorder, County of LINCOLN. This "corner record" was filed for record on FEB 3, 1997 and was noted on the cross-index plat and is assigned page No. 9211, in book No. CORAL M. CUMMINGS

County Official *B. J. B.*

Sec. 28

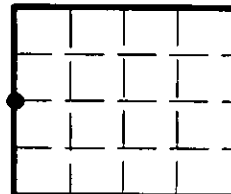

● - corner this sheet

