

CERTIFIED CORNER RECORDATION

Corner 1/4 Secs. 10 & 11 T. 35N R. 26W P.M., MT Lincoln County

- I. 1894 G.L.O. Original record by Frank L. Sizer et. al.: Set a post 3 ft. long, 3 ins. square, 24 ins. in the ground, for 1/4 sec. cor., mkd. "1/4 S" on W. face, and established two bearing trees:
 A fir, 6 ins. diam., bears S16°30'E, 40 lks. dist., mkd. "1/4 S BT".
 A fir, 6 ins. diam., bears S6°15'W, 26 lks. dist., mkd. "1/4 S BT".

1959 B.L.M. Remonumentation record by David R. Cunningham et. al.: The 1/4 sec. cor. of secs. 10 and 11, monumented with a limestone, 16x10x5 ins., firmly set in the ground, mkd. 1/4 on W. face, and witnessed by the remains of the two original bearing trees. At the corner point, set an iron post, 30 ins. long, 2 1/2 ins. diam., 26 ins. in the ground, in concrete, with brass cap mkd. as shown:

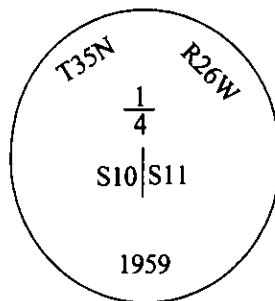

From which, the orig. bearing trees:

- A fir stump, 10 ins. diam., bears S16 1/2°E, 40 lks. dist., "S BT" visible.
 A fallen fir, 9 ins. diam., bears S17°W, 26 lks. dist., "1/4 S BT" visible.

Establish two new bearing trees, bury original stone alongside, and raise a mound of stone, 2 ft. base, 1.5 ft. high, W. of the iron post.

- II. Found a 2 1/2 in. diam. iron post, firmly set, protruding 2 ins. above the ground, with a 3 1/4 in. diam. B.L.M. brass cap, mkd. as shown above.

From which:

- A fir, 12 ins. diam., bears S12°E, 34.3 ft. dist., mkd. with a healed face. (BLM-record)
 A fir, 11 ins. diam., bears S55°W, 9.2 ft. dist., mkd. with a healed face. (BLM-record)
 No evidence found of orig. bearing trees.

- III. Painted bearing trees and attached Land Survey Monument and Bearing Tree signs.

Set a 6 ft. steel guard post with Land Survey Marker and Property Boundary decals, South, 3 feet.

Magnetic Declination: 20° East.

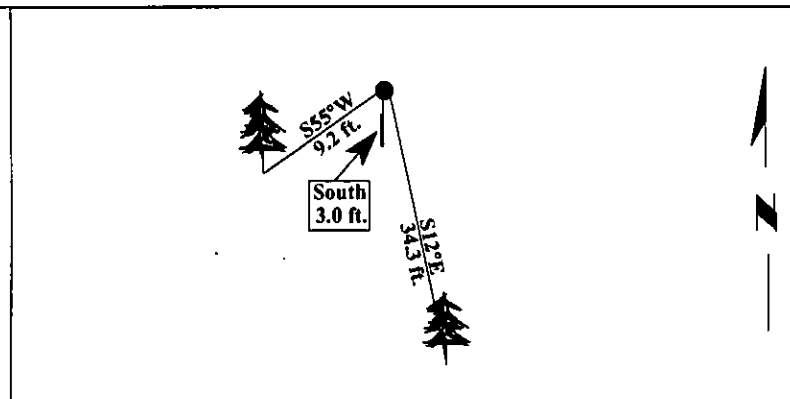

SKETCH OF CORNER

CERTIFICATION

- I. Mark Federman
 certify the information shown herein is true and correct.

- I. Alvah F. Hughes
 certify that this Corner Record correctly represents work performed by me or under my direction in compliance with the "Corner Recordation Act" (70-22-101, et seq., M.C.A.)

Date: 12/28/96

Reg. No.: 7322LS

Employer: U.S. FOREST SERVICE

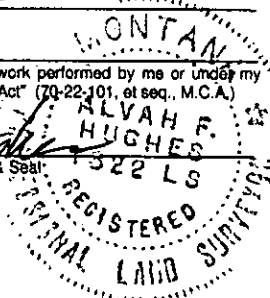

Office of Clerk and Recorder, County of LINCOLN. This "corner record" was filed for record on FEB 3, 1997 and was noted on the cross-index plat and is assigned page No. 9119, in book No. CORAL M. CUMMINGS

County Official B. J. B.

Sec. 11

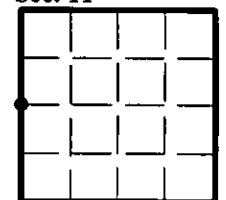

• - corner this sheet

Cross Index No. G-17 T. 35N R. 26W P.M., MT

