

CERTIFIED CORNER RECORDATION

Corner CW 1/16 Sec 13 T. 35N R. 26W P.M.M. Lincoln County

Found:
Nothing.

Established:
A 3 1/4 ins. Aluminum cap on 5/8 inch rebar, 0.4 ft. above ground, stamped as shown.
A D Fir, 8 ins. in diam. bears N52°E, 38.6 ft. dist., scribed CW 1/16 S 13 BT.
A D Fir, 8 ins. in diam. bears S44°E, 28.6 ft. dist., scribed CW 1/16 S 13 BT.
A Steel post with LSM decal, bears North 2 ft. and South 2 ft.



MAGNETIC DECLINATION - 15°4' EAST

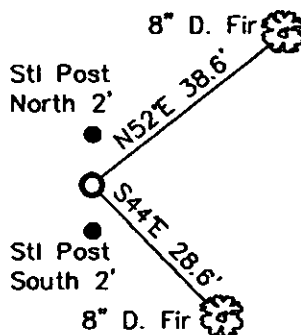
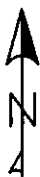

SKETCH OF CORNER

CERTIFICATION

I, Erich Shrack
certify the information shown herein is true and correct.

LAWRENCE A. GLAHE
certify that this Corner Recordation was performed by me or under my supervision in compliance with the "Corner Recordation Act" (Mont. Code Annotated, et seq. M.C.A.)

Date: 12/10/2010 9748 LS
Employer: GLAHE & ASSOC., INC.

Office of Clerk and Recorder, County of Lincoln. This "corner

record" was filed for rec: 230127 BOOK: CCR CC&R'S PAGE: 11725 Pages: 1

was noted on the cross- STATE OF MONTANA LINCOLN COUNTY

book No. TAMMY D. LAUER CLERK AND RECORDER

FEE: \$0.00 BY: Lawrence Glahe
TO: GLAHE & ASSOC., INC. P.O. BOX 1863, SANDPOINT, ID. 83860,

Cross Index No. L-22 T. 35N R. 26W PMM

Adopted July 1, 1981, Montana Board of Professional Engineers & Land Surveyors

Sec. 13

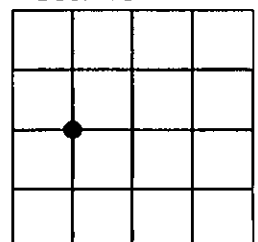

● corner this sheet

