

CERTIFIED CORNER RECORDATION

Corner 1/4 COR. SECS. 1 & 12

T. 35N. R. 26W., PMM

LINCOLN County

RECORD:

GLO 1894 Set a Limestone 12X10X8 ins, 8 ins in the ground, mked 1/4 on N face
from which a pine 36" diam bears S19°30'E 115 lks dist marked 1-4 S BT
A pine 30" diam bears N1°E 72 lks dist marked 1-4 S BT

(1989) C.O.S. No. 1711, set 3 1/4" alum. cap by single proportion
(1990) C.O.S. No. 1781, found 3 1/4" cap
(1992) C.O.S. No. 1907, found AC
(1996) PLAT No. 5703, found AC

FOUND:

No original accessories were found nor were the 2 trails which were mentioned in the GLO field notes.
The position is at a fence intersection in a cultivated pasture.

Found a 3 1/4" AC marked as shown below in a 2' mound of stone,
from which we found the references:

A 1" pipe set firmly in the ground bears, S.44°W., 21.1' I was unable to determine origin of the 1" pipe,
although it appears to have been used in the past as the 1/4 corner.

I accept the Aluminum cap as the position for the corner.

SET:

Set a B.T. tag on a 4" fence post bears, west 0.8'
Set a MDT witness post with decal 1' northerly
SEE DETAIL BELOW

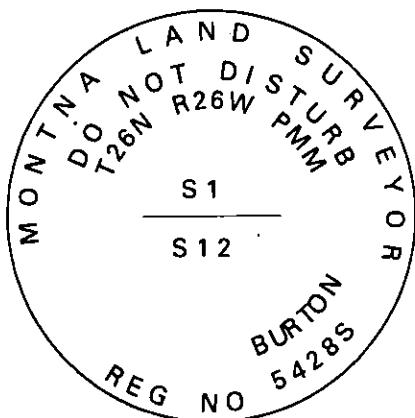

SKETCH OF CORNER

CERTIFICATION

I, Jim Turner

certify the information shown herein is true and correct.

Signature of Ground Party Chief

I, Donald M. Roedel

certify that this Corner Record correctly represents work
performed by me, or under my direction, in compliance with
the "Corner Recordation Act" (70-22-101, et seq., MCA)

Signature of Surveyor & Seal

Date: 9-10-03 Reg. No. 10999LS

Employer: MDT

Sec. 12

Office of Clerk and Recorder, County of LINCOLN. This "corner
record" was filed for record on 9-10-03
was noted on the cross-index plat, and is assigned Page No. 10620, in Book No. E 23

E 23

J. d. R.
County Official

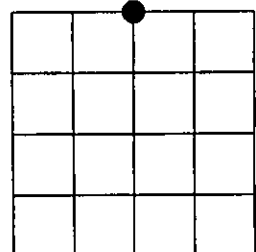

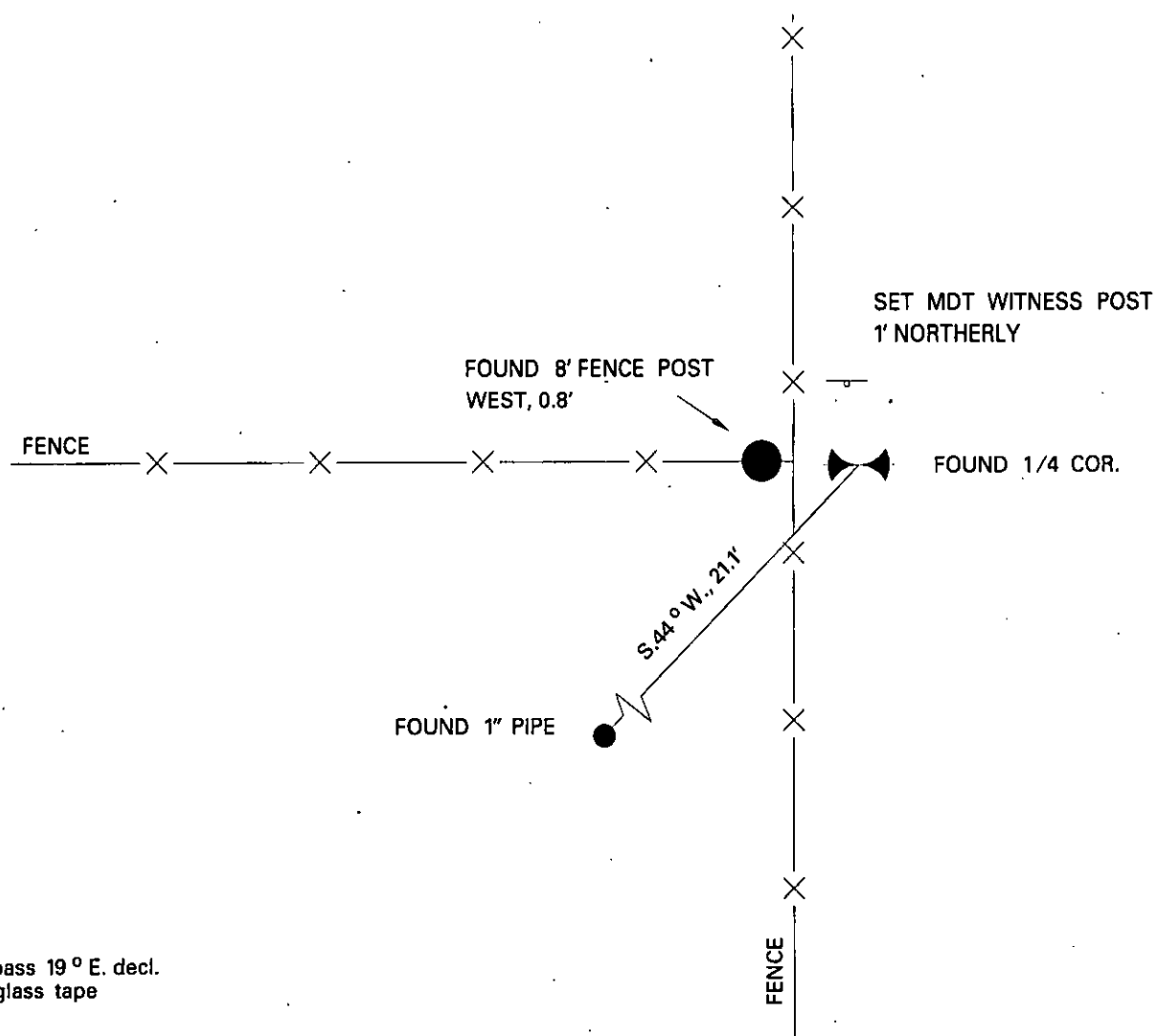

Bearings by Silva compass 19° E. decl.
Distance by fiberglass tape