

CERTIFIED CORNER RECORDATION

Corner 1/4 Sec. 33&34 T. 35N R. 26W P.M., MT Lincoln County

- I. 1894 G.L.O. Original Record by Frank L. Sizer et. al.: Set a wooden post, 3 ft. long 3 ins. square, 24 ins. in the ground, for 1/4 sec. cor., mkd. "1/4 S" on W. face. Established two bearing trees.

1960 Remonumentation Record by David R. Cunningham et. al.: The 1/4 sec. cor. of secs. 33 and 34, as determined from the remains of the two original bearing trees. At the corner point, set an iron post, 30 ins. long, 2 1/2 in. diam., 25 ins. in the ground, in concrete, with brass cap mkd. as shown.

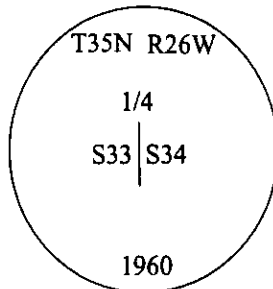

Established two new bearing trees and raise a mound of stone, 3.5 ft. base, 2.5 ft. high, West of the iron post.

- II. Found a B.L.M. brass cap, protruding 2 ins. above the ground, firmly set, mkd. as shown above. A mound of stone of stone, 3 ft., West of the monument.

from which:

- A rotten stump, bears S46°E, 8.6 ft. dist., with visible scribe. (GLO-record)
- A fir, 9 ins. diam., bears S48°E, 24.2 ft. dist., with a healed face. (BLM-record-36 lks., 23.76 ft)
- A rotten stump, bears S53°E, 29.55 ft. dist., with visible scribe. (GLO-record-46 lks., 30.36 ft.)
- A fir, 13 ins. diam., bears S22°W, 15.2 ft. dist., with a healed face. (BLM-record)

- III. Painted bearing trees and attached Land Survey Monument and Bearing Tree signs.

Magnetic Declination: 20° East.

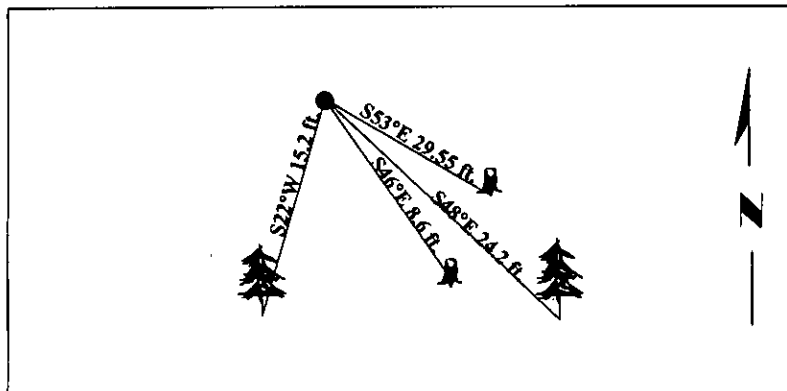

SKETCH OF CORNER

CERTIFICATION

I, Mark Federman
certify the information shown herein is true and correct.

Alvah F. Hughes
certify that this Corner Record correctly represents work performed by me or under my direction in compliance with the "Corner Recordation Act" (70-22-101, et seq., M.C.A.).

Signature of Surveyor & Seal

Date: 07/18/97

Reg. No.: 7322LS

Employer: U.S. FOREST SERVICE

Office of Clerk and Recorder, County of Lincoln. This "corner record" was filed for record on 12-26-97 was noted on the cross-index plat and is assigned page No. 10048 in book No. _____

Coral M. Cummins
County Official

