

CERTIFIED CORNER RECORDATION

Corner 1/4 Sec. 32&33 T. 35N R. 26W P.M., MT Lincoln County

I. 1894 G.L.O. Original Record by Frank L. Sizer et. al.: Set a post, 3 ft. long, 3 ins. square, 24 ins. in the ground, for 1/4 sec. cor. mkd. "1/4 S" on W. face. Established two bearing trees.

1959 Remonumentation Record by David R. Cunningham et. al.: The 1/4 sec. cor. of secs. 32 and 33, as determined from the remains of the wooden post and witnessed by the original bearing trees. At the corner point, set an iron post, 30 ins. long, 2 1/2 in. diam., 25 ins. in the ground, in concrete, with brass cap mkd. as shown.

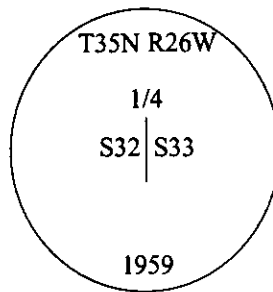

Established two new bearing trees and buried the remains of the wooden post alongside the iron post.

II. Found a B.L.M. brass cap, protruding 6 ins. above the ground, firmly set, mkd. as shown above.

from which:

A larch, 13 ins. diam., bears N74°E, 26.1 ft. dist., with a healed face. (BLM-record-39 lks., 25.7 ft.)

A rotten larch stump, bears S68°E, 17.8 ft. dist., "BT" visible. (GLO-record)

A rotten stump, bears N50°W, 3.3 ft. dist., no visible marks. (GLO-record)

A fir stump, 12 ins. diam., bears N70°W, 15.2 ft. dist., with a healed face. (BLM-record)

III. Established one new bearing tree:

A fir, 8 ins. diam., bears S25°W, 17.2 ft. dist., mkd. "1/4 S32 BT".

Painted bearing trees and attached Land Survey Monument and Bearing Tree signs.

Magnetic Declination: 20° East.

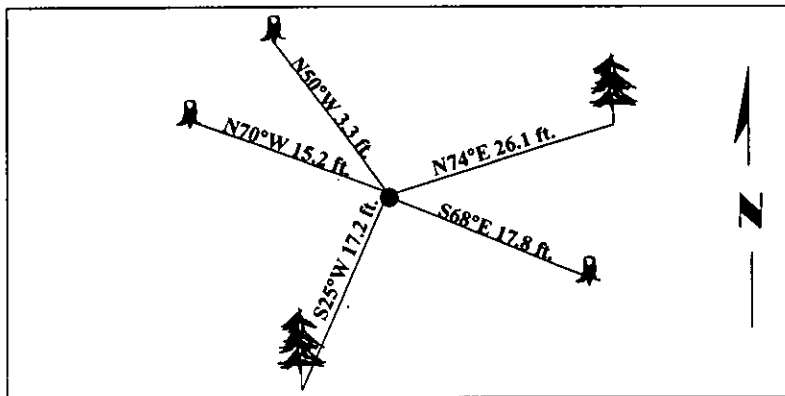

SKETCH OF CORNER

CERTIFICATION

I, Mark Federman
certify the information shown herein is true and correct.

Alvah F. Hughes
certify that this Corner Record correctly represents work performed by me or under my direction in compliance with the "Corner Recordation Act" (70-22-101, et seq., M.C.A.)

Signature of Surveyor: Alvah F. Hughes

Date: 07/18/97

Reg. No.: 7322LS

Employer: U.S. FOREST SERVICE

Office of Clerk and Recorder, County of Lincoln. This "corner record" was filed for record on 12-26-97 was noted on the cross-index plat and is assigned page No. 10047 in book No. _____

Coral M. Cunningham
County Official

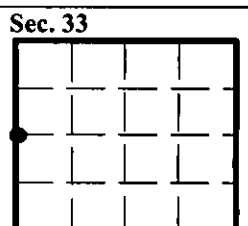

• - corner this sheet

Cross Index No. X-9 T. 35N R. 26W P.M., MT

