

CERTIFIED CORNER RECORDATION

Corner CE 1/16 Sec. 18 T. 35N R. 26W P.M., MT Lincoln County

- I. No history found.
- II. No evidence found.
- III. Set by survey, an aluminum rod, 30 ins. long, 3/4 in. diam., 27 ins. in the ground, with a 3 1/4 in. diam. aluminum cap mkd. as shown below:

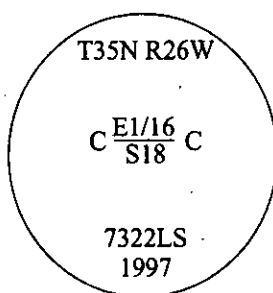

Established two bearing trees:

- A fir, 13 ins. diam., bears S23°W, 28.9 ft. dist., mkd. "CE 1/16 S18 BT".
- A larch, 8 ins. diam., bears S89°W, 21.0 ft. dist., mkd. "CE 1/16 S18 BT".

Set a 6 ft. galvanized steel guard post, West, 3.0 ft. dist. with a Land Survey Monument decal attached.

Painted bearing trees and attached Land Survey Monument and Bearing Tree signs.

Magnetic Declination: 20° East.

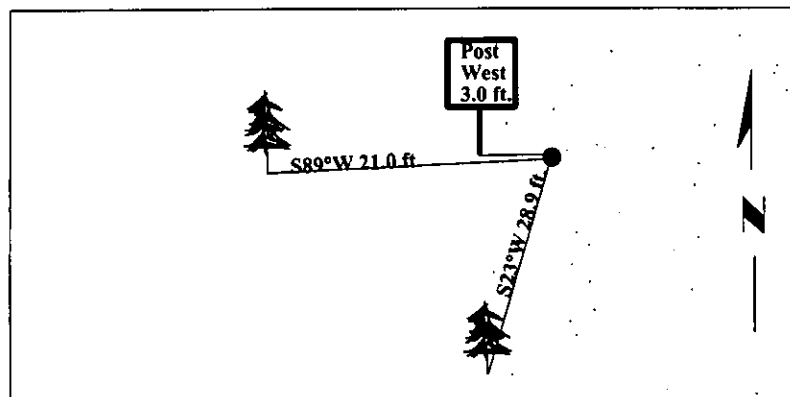

SKETCH OF CORNER

CERTIFICATION	
I, <u>Thomas Hommel</u>	certify the information shown herein is true and correct.
I, <u>Alvah F. Hughes</u>	certify that this Corner Record correctly represents work performed by me or under my direction in compliance with the "Corner Recordation Act" (70-22, 101st sess., M.C.A.)
Date: <u>11/24/97</u>	Signature of Surveyor & Seal
Reg. No.: <u>7322LS</u>	
Employer: <u>U.S. FOREST SERVICE</u>	

Office of Clerk and Recorder, County of Lincoln. This "corner record" was filed for record on 12-26-97 was noted on the cross-index plat and is assigned page No. 10003 in book No. _____

County Official

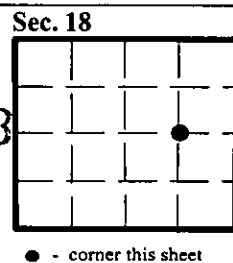

[illegible][illegible]