

CERTIFIED CORNER RECORDATION

Corner NW 1/16 Sec. 19 T. 35N R. 26W P.M., MT Lincoln County

- I. No history found.
- II. No evidence found.
- III. Set by survey, an aluminum rod, 30 ins. long, 3/4 in. diam., 28 ins. in the ground, with a 3 1/4 in. diam. aluminum cap mkd. as shown below:

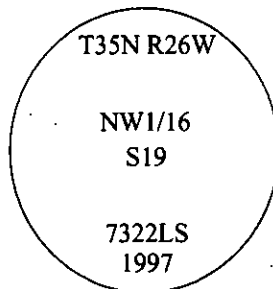

Established two bearing trees:

- A larch, 10 ins. diam., bears N39°E, 28.5 ft. dist., mkd. "NW 1/16 S19 BT".
- A fir, 10 ins. diam., bears S64°E, 16.5 ft. dist., mkd. "NW 1/16 S19 BT".

Set two 6 ft. galvanized steel guard posts, West and South, both 4.0 ft. dist. with Property Boundary and Land Survey Monument decals attached.
Painted bearing trees and attached Land Survey Monument and Bearing Tree signs.

Magnetic Declination: 20° East.

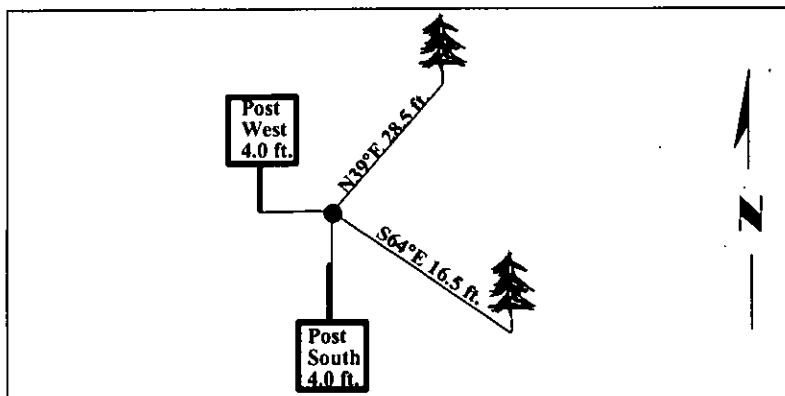

SKETCH OF CORNER

CERTIFICATION	
I. <u>Thomas Mommel</u>	certify the information shown herein is true and correct.
I. <u>Alvah F. Hughes</u>	certify that this Corner Record correctly represents work performed by me or under my direction in compliance with the "Corner Recordation Act" (70-22-101, et seq., M.C.A.)
Date: <u>11/25/97</u>	Signature of Surveyor & Seal
Reg. No.: <u>7322LS</u>	
Employer: <u>U.S. FOREST SERVICE</u>	

Office of Clerk and Recorder, County of Lincoln. This "corner record" was filed for record on 12-26-97 was noted on the cross-index plat and is assigned page No. 10000 in book No. _____

Coral M. Cumming By DAB
County Official

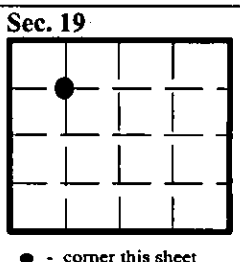

• - corner this sheet

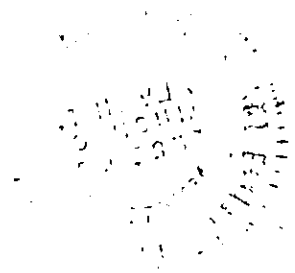

1962