

CERTIFIED LAND CORNER RECORDATION
(REFERENCE FSM 7153.53)

DESCRIPTION OF CORNER EVIDENCE FOUND, AND ORIGINAL RECORD (IF KNOWN)

FOUND AN UNRECORDED 5/8" REBAR W/ PLASTIC CAP STAMPED
"2989 ES." IN THE POSITION OF THE CN 1/16 SECTION 18

STEEL FENCE POST MARKING APPROX POSITION, BEARS N 5°W, 13.5 FT.

DESCRIPTION OF MONUMENT AND ACCESSORIES ESTABLISHED
TO PERPETUATE THE ORIGINAL LOCATION OF THIS CORNER:

Date of work: 6/3/80

AT THE CORNER POINT, OVER THE FOUND REBAR:
SET A 2 1/2" X 30" ALUMINUM PIPE APPROX 25" IN GROUND WITH ALUM.
CAP MARKED AS SHOWN. COLLAR OF STONE.

FROM WHICH: A 5" LARCH BEARS N 44°W, 27.2 FT, MKRD "X BT"
AN 8" LARCH BEARS S 01°E, 7.3 FT, MKRD "CN 1/16 SIB BT"

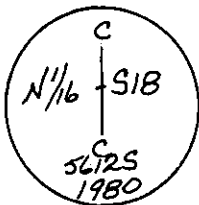

ATTACHED LOCATION POSTER TO A 5" LARCH WHICH BEARS S 37°E, 11.1 FT
PAINTED RED BANDS ON BEARING TREES.

SKETCH, WITH COURSE AND DISTANCE TO ADJACENT CORNERS IF DETERMINED IN THIS SURVEY.
(MAY SKETCH OR PASTE REPRODUCTION ON REVERSE SIDE.)

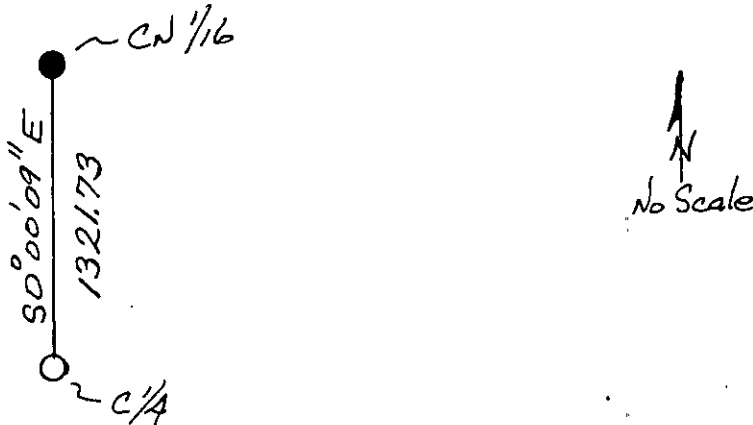

Surveyor's Seal

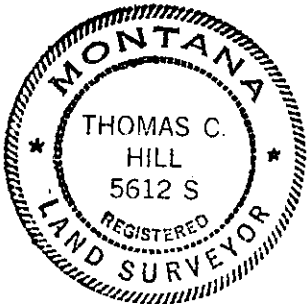

I, ANTHONY J. BACHMAN
certify that the information shown herein is true and correct.

Anthony J. Bachman
Signature of Ground Party Chief

I, THOMAS C. HILL
certify that I have carefully performed or reviewed the work done on the diagrammed corner as reported on this recordation form and approve the same.

Thomas C. Hill
Signature of Surveyor

DIAGRAM OF CORNER:
T 35N R 25W
CN 1/16
SEC 18

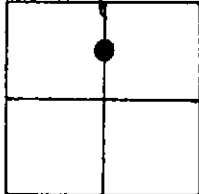

● = Corner recorded on the sheet

5612 S
Registration Number

Office of Clerk and Recorder, County of Lincoln

This "corner record" was filed for record on the 15th day of December, 1980, was noted on the cross-index plat and is assigned page No. 944, in book No. 1

Charles L. Vaughan by Betty Lee
County Official

Cross Index No. K-3 T. 35N R. 25W Mer.

