

INSTRUCTIONS

1. Original and/or subsequent record used to evaluate the corner position.
2. Description of evidence found, note discrepancies in the record, state method of establishing lost or obliterated corners.
3. Description of monument and accessories set to perpetuate the corner position.
4. Sketch of corner, show all pertinent data which can best be shown in a sketch example, corner marking, topography ties, position of accessories, etc.
5. Certification must be signed and sealed by Land Surveyor registered in the State of Montana.
6. Fill in Cross Index & Section Diagram at bottom of sheet.

CERTIFIED CORNER RECORDATION

Corner 3 of HES 785 T. 35 N. R. 25 W. P.M.M. Lincoln County

I. 1917 H.E.S. original record by R. E. Maurer: " Cor. No. 3 of this survey, as follows:

Set for Cor No. 3, a small stone, marked with a cross (X), under a sandstone 24x9x9 ins. 14 ins. in the ground, marked 3 H.E.S. 785 on the SE. face and a cross on top for the exact corner point, from which: " Two bearing trees. A mound of earth 4 ft. base, 2 ft. high, SE. of corner.

1960 B.L.M. Resurvey by D. Cunningham: " Cor. No. 3 of H.E.S. No. 785, monumented with a quartzite stone, 24x9x9 ins., set and marked as described in the official record and witnessed by the remains of the original bearing trees. At corner point set an iron post, 30 ins. long, 2 1/2 ins. diam., 26 ins. in the ground, in concrete, with brass cap mkd.

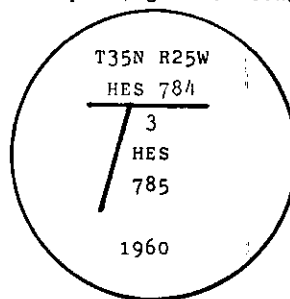

from which

The remains of the original bearing trees:

A stump hole, bears N.47°04'E., 19 lks. dist., with fallen log mkd. X 3 HES 785 BT.
(1917 original record: S.47°09'E., 19 lks.)

A larch, 11 ins. diam., bears N.6°46'W., 27 lks. dist., mkd. X 3 HES 785 BT.
(Record: S.6°46'W., 27 lks.)

The new bearing tree:

A larch, 9 ins. diam., bears S.75-1/2°E., 22 lks. dist., mkd. 3 HES 785 BT.

A larch, 10 ins. diam., bears S.42-1/4°E., 100 lks. dist., mkd. 3 HES 785 BT.

Bury the original stone alongside and raise a mound of stone, 3 ft. base, 2 ft. high, SE. of the iron post."

II. Found a BLM brass cap, 3 1/4 ins. diam., 2 ins. out of the ground, with a rock mound 1 ft. South of corner, mkd. as shown above.

From which:

A larch, dead and down, bears S.7°W., 17.8 ft. (27.0 lks.) dist., mkd. 3 HES 785 (Original)
(The BLM: N.6°46'W.)

A larch, 12 ins. diam., bears S.41°W., 66.1 ft. (100.2 lks.) dist., healed face.
(1960: S.42-1/4°E.)

III. Established one new bearing tree:

A cedar, 9 ins. diam., bears N.58°W., 44.4 ft. dist., mkd. 3 HES 785 BT.

Painted red bands around the bearing trees and attached "Land Survey Monument" and "Bearing Tree" signs.

Set a 6 ft. galvanized steel guard post with "Land Survey Marker" and "Property Boundary" decals, S46°W, 3 ft. dist from corner.

Magnetic declination: 20° East

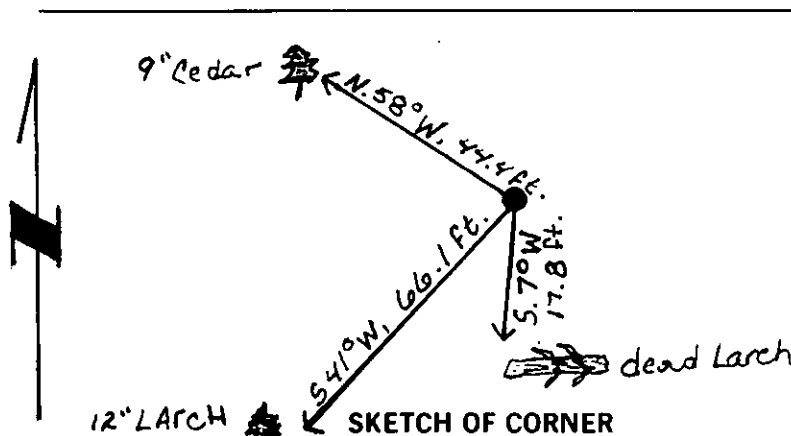

SKETCH OF CORNER

CERTIFICATION

I, Thomas M. Hommel
certify the information shown herein is true and correct.

Signature of Surveyor

I, Alvah F. Hughes
certify that this Corner Record correctly represents the corner formed by me or under my direction in compliance with the "Corner Recordation Act" (70-22-101, et seq., M.C.A.)

Signature of Ground Party Chief

Date: 4/27/91 Reg. No. 73227

Employer: U.S. FOREST SERVICE

Office of Clerk and Recorder, County of Lincoln. This "corner record" was filed for record on MAY 25, 1995 was noted on the cross-index plat and is assigned page No. 7500, in book No. Coral M. Cumming By DB

County Official

3 HES 785 35 N 25 W

Cross Index No. T. R. PMM

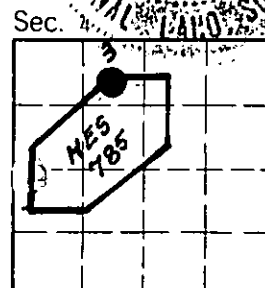

Sec. 4 corner this sheet

T

1955
HUGHES
HAYDA
1955

1955
HUGHES
HAYDA
1955

