

INSTRUCTIONS

1. Original and/or subsequent record used to evaluate the corner position.
2. Description of evidence found, note discrepancies in the record, state method of establishing lost or obliterated corners.
3. Description of monument and accessories set to perpetuate the corner position.
4. Sketch of corner, show all pertinent data which can best be shown in a sketch example, corner marking, topography ties, position of accessories, etc.
5. Certification must be signed and sealed by Land Surveyor registered in the State of Montana.
6. Fill in Cross Index & Section Diagram at bottom of sheet.

CERTIFIED CORNER RECORDATION

Corner 4 of HES 786 T. 35 N. R. 25 W. P.M.M. Lincoln County

I. 1917 H.E.S. original record by R. E. Maurer: " Cor. No. 4 of this survey, as follows:

Set for Cor No. 4 a small stone, marked with a cross (X) under a slate stone 26x16x7 ins., 16 ins. in the ground, mkd. 4 H.E.S. 786 on the NW. face and a cross on top for the exact corner point. From which: Mkd. two bearing trees and raised a mound of stone 4 ft. base, 2 ft. high, NW. of corner.

1960 B.L.M. Resurvey by D. Cunningham: " Cor. No. 4 of H.E.S. No. 786, monumented with a slate stone, 24x16x7 ins., set and marked as described in the official record and witnessed by the remains of the original bearing trees. At corner point set an iron post, 30 ins. long, 2 1/2 ins. diam., 26 ins. in the ground, in concrete, with brass cap mkd.

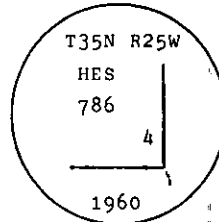

from which

The original bearing trees:

A fir, 9 ins. diam., bears N. 77° 00' W., 42 lks. dist., marking overgrown. (Record)

A larch stump, 18 ins. diam., bears N. 30° 37' W., 44 lks. dist., mkd. X 4 HES 786 BT. (Record)

The new bearing tree:

A larch, 6 ins. diam., bears S. 83-3/4° E., 22 lks. dist., mkd. 4 HES 786 BT.

Bury the original stone alongside and raise a mound of stone, 3 ft. base, 2 1/2 ft. high, NW. of the iron post."

II. Found a BLM brass cap 3 1/4 ins. diam., flush with ground with rock mound 1 ft. East of corner, mkd. as shown above.

From which:

A larch stump, bears N30° W., 29.4 ft. (44.5 lks.) dist., visible scribing. (Original)

A fir, 17 ins. diam., bears N77° W. 28.6 ft. (43.3 lks.) dist., healed face. (Original)

A larch, 18 ins. diam., bears N70° E., 6.0 ft. (9.1 lks.) dist., W H 3 visible. (No record)

A larch stump, bears S86° E., 15.9 ft. (24.1 lks.) dist., W H 3 visible. (No record)

A larch, 8 ins diam., bears S83° E., 15.0 ft. (22.7 lks.) dist., healed face.

A larch, 16 ins. diam., bears S88° W., 13.9 ft. (21.1 lks.) dist., W visible. (No record)

III. Painted red bands around the bearing trees and attached "Land Survey Monument" and "Bearing Tree" signs where needed.

Set a 6 ft. galvanized steel guard post with "Land Survey Marker" and "Property Boundary" decals, West, 3 ft. dist from corner.

Magnetic declination: 20° East

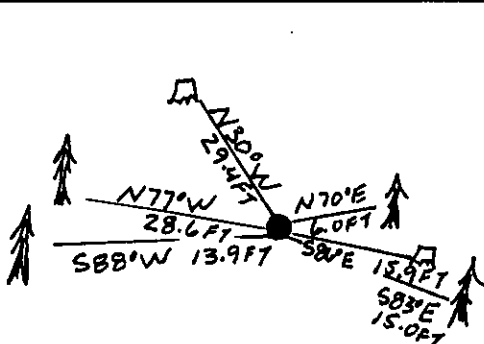

SKETCH OF CORNER

CERTIFICATION

I, Tom Hommel

certify the information shown herein is true and correct.

Tom Hommel
Signature Ground Party Chief

I, Alvah F. Hughes

certify that this Corner Record correctly represents work performed by me or under my direction in compliance with the "Corner Recordation Act" (70-22-101, et seq., M.C.A.)

Alvah F. Hughes
Signature of Surveyor & Seal

Date: 11/26/91 Reg. No. 9008 L.S.

Employer: U.S. FOREST SERVICE

Office of Clerk and Recorder, County of Lincoln. This "corner record" was filed for record on 4-21-92 was noted on the cross-index plat and is assigned page No. 5020, in book No. Coral M. Cummings

County Official

Cross Index No. 4 HES 786 T. 35 N R. 25 W P.M.M.

Sec. 4

	COR 4		
	HES 786		

• - corner this sheet

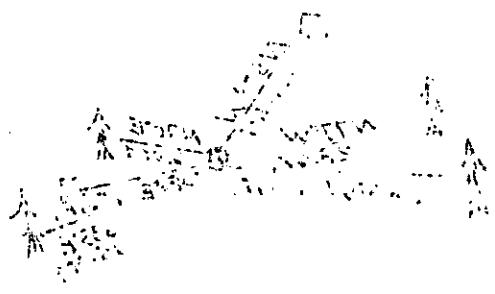
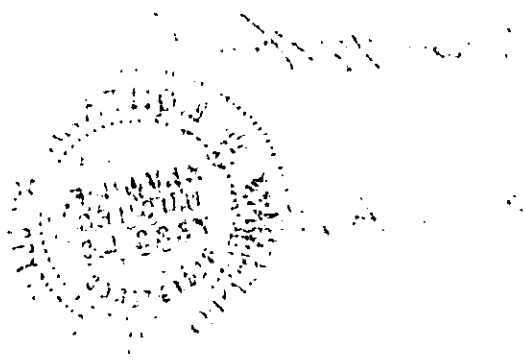
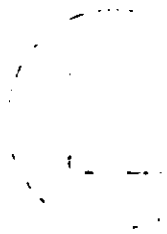

100-100000
JUN 19 1964

11