

INSTRUCTIONS

1. Original and/or subsequent record used to evaluate the corner position.
2. Description of evidence found, note discrepancies in the record, state method of establishing lost or obliterated corners.
3. Description of monument and accessories set to perpetuate the corner position.
4. Sketch of corner, show all pertinent data which can best be shown in a sketch example, corner marking, topography ties, position of accessories, etc.
5. Certification must be signed and sealed by Land Surveyor registered in the State of Montana.
6. Fill in Cross Index & Section Diagram at bottom of sheet.

CERTIFIED CORNER RECORDATION

Corner 4 of HES 787 T. 35 N. R. 25 W. Lincoln County

I. 1917 H.E.S. original record by R. E. Maurer: " Cor. No. 4 of this survey, as follows:

Set for Cor No. 4, a small stone, marked with a cross (X) under a sandstone, 26x14x6 ins. 16 ins. in the ground, marked 4 H.E.S. 787 on the SW. face and a cross on top for the exact corner point. From which:

A cross (X) on a tamarack tree, 10 ins. dia., bears S. $7^{\circ} 42'$ E., 112 lks. dist.,

A cross (X) on a tamarack tree, 6 ins. diam., bears N. $12^{\circ} 56'$ E., 158 lks. dist., each blazed and scribed 4 H E S 787 B T.

Raise a mound of earth 4 ft. base, 2 ft. high, SW. of corner."

1960 B.L.M. Resurvey by D. Cunningham: " Cor. No. 4 of Tract A, H.E.S. No. 787, monumented with a sandstone, 24 x 16 x 6 ins., set and marked as described in the official record and witnessed by one of the original bearing trees. At the corner point set an iron post, 30 ins. long, 2 1/2 ins. diam., 26 ins. in the ground, in concrete, with brass cap mkd.

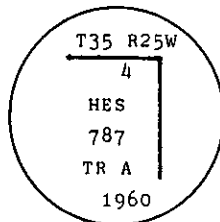

from which

The original bearing tree:

A larch, 12 ins. diam., bears N. $1^{\circ} 54'$ W., 156 lks. dist., mkd. X 4 HES 787 BT.
(Record: N. $12^{\circ} 56'$ E., 158 lks.)

The new bearing trees:

A fir, 9 ins. diam., bears S $26^{\circ} 1/2'$ E., 7 lks. dist., mkd. 4 HES 787 BT.

A fir, 14 ins diam., bears N. $73^{\circ} W.$, 76 lks. dist., mkd. 4 HES 787 BT.

Bury the original stone alongside and rebuild the mound of stone, 3 ft. base, 2 ft. high, SW. of the iron post.

II. Found a B.L.M. brass cap on 2 1/2 ins. diam. iron pipe, 2 ins. above ground with rock collar, mkd. as shown above, from which:

A larch, 11 ins. diam, bears North, 102.9 ft. (155.9 lks.) dist., visible scribing. (Original.)

A fir, 20 ins. diam., bears N $72^{\circ} W.$, 50.1 ft. (75.9 lks.) dist., healed face.

A fir stump, S $22^{\circ} E.$, 4.6 ft. (7.0 lks.) dist., mkd. 4 HES 787 BT, visible scribing.

III. Establish:

Painted red bands around the bearing trees and attached "Land Survey Monument" and "Bearing Tree" signs.

Set a 6 ft. galvanized steel guard post with "Land Survey Marker" and "Property Boundary" decals, West, 4 ft. dist from corner.

Magnetic declination: 20° East

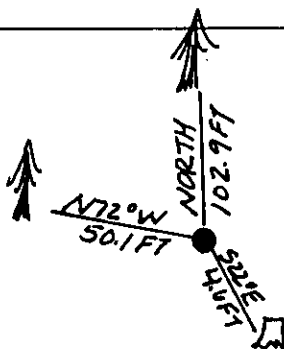

SKETCH OF CORNER

CERTIFICATION

I, Tom Hommel

certify the information herein is true and correct.

Thomas M. Hommel
Signature Ground Party Chief

I, Alvah F. Hughes

certify that this Corner Record correctly represents work performed by me or under my direction in compliance with the Corner Recordation Act" (70-22-101, et seq. M.C.A.)

Alvah F. Hughes
Signature of Surveyor

Date: 11/26/91 Reg. No. 7322

Employer: U.S. FOREST SERVICE

Sec. 6

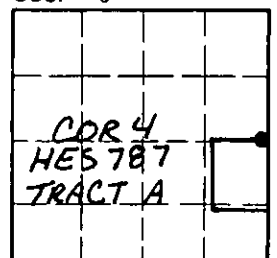

Office of Clerk and Recorder, County of Lincoln. This "corner record" was filed for record on 4-21-92

was noted on the cross-index plat and is assigned page No. 5008, in book No. Coral M. Cummings

County Official

4 HES 787

35 N 25 W

Cross Index No. T. R. PMM

• - corner this sheet

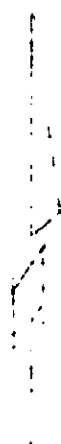
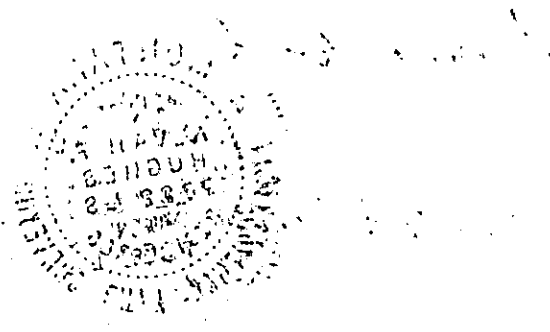

1964
MAY 19

1964
MAY 19
U.S. POSTAGE