

INSTRUCTIONS

1. Original and/or subsequent record used to evaluate the corner position.
2. Description of evidence found, note discrepancies in the record, state method of establishing lost or obliterated corners.
3. Description of monument and accessories set to perpetuate the corner position.
4. Sketch of corner, show all pertinent data which can best be shown in a sketch example, corner marking, topography ties, position of accessories, etc.
5. Certification must be signed and sealed by Land Surveyor registered in the State of Montana.
6. Fill in Cross Index & Section Diagram at bottom of sheet.

CERTIFIED CORNER RECORDATION

Corner 4 of HES 784 T. 35 N. R. 25 W. Lincoln County

- I. 1917 H.E.S. original record by R. E. Maurer: "Set for Cor. No. 4 a slate stone, 26x8x6 ins. 16 ins. in the ground, marked 4 HES 784 on the NW. face, and a cross (X) on top for exact corner point. From which: "Two bearing trees. A mound of stone 4 ft. base, 2 ft. high, NW. of corner. 1960 B.L.M. Resurvey by D. Cunningham: "Cor. No. 4 of H.E.S. No. 784, monumented with a slate stone, 24x6x4 ins., set and marked as described in the official record, and witnessed by the remains of the original bearing trees. At the corner point set an iron post, 30 ins. long, 2 1/2 ins. diam., 26 ins. in the ground, in concrete, with brass cap mkd.:

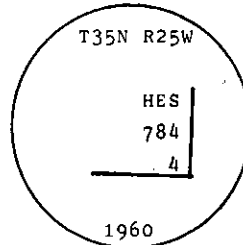

from which

The remains of the original bearing trees:

A larch stump, 12 ins. diam., bears N. 54° 47' W., 63 lks. dist., mkd. X 4 HES 784 BT. (Record)

A stump hole, bears N. 12° 50' W., 80 lks. dist., with fallen log mkd. X. (Record)

The new bearing trees:

A fir, 6 ins. diam., bears N. 65-1/2° W., 39 lks. dist., mkd. 4 HES 784 BT.

A fir, 6 ins. diam., bears N. 0° 45' W., 28 lks. dist., mkd. 4 HES 784 BT.

Bury the original stone alongside and raise a mound of stone, 3 ft. base, 2 ft. high, NW. of the iron post."

- II. Found a BLM brass cap 3 1/4 ins. diam., flush with the ground with a rock mound 1 ft. West of corner. Brass cap marked as shown above.

From which:

A larch stump, bears N54° W., 41.5 ft. (62.9 lks.) dist., no visible scribing. (Original)

A fir, 8 ins. diam., bears N2° E., 18.9 ft. (28.6 lks.) dist., HES 784 visible.

(1960: N0° 45' W., 28 lks. dist.)

A fir, 9 ins. diam., bears N64° W, 25.7 ft. (38.9 lks.) dist., healed face.

(1960: N65 1/2° W., 39 lks.)

Rotten remains, bears N13° W., 52.8 ft. (80.0 lks.) dist. (Original)

III. Establish:

Painted red bands around the bearing trees and attached "Land Survey Monument" and "Bearing Tree" signs.

Set a 6 ft. galvanized steel guard post with "Land Survey Marker" and "Property Boundary" decals, North, 2 ft. dist from corner.

Magnetic declination: 20° East

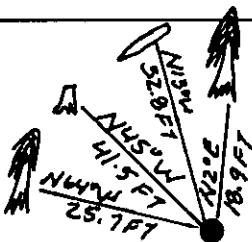

SKETCH OF CORNER

CERTIFICATION

1. Tom Hommel

certify the information shown herein is true and correct

Thomas M. Hommel
Signature Ground Party Chief

1. Alvah F. Hughes

certify that this Corner Record correctly represents work performed by me or under my direction in compliance with the "Corner Recordation Act" (70-22-101, et seq., M.C.A.)

Alvah F. Hughes
Signature of Surveyor & Seal

Date: 11/26/91 Reg. No. 7322 LS

Employer: U.S. FOREST SERVICE

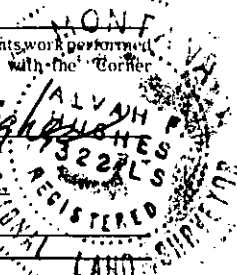

Office of Clerk and Recorder, County of Lincoln. This "corner record" was filed for record on 4-21-92 was noted on the cross-index plat and is assigned page No. 5005 in book No. Coral M. Cummings

County Official

4 HES 784

35 N 25 W

Cross Index No. T. R. PMM

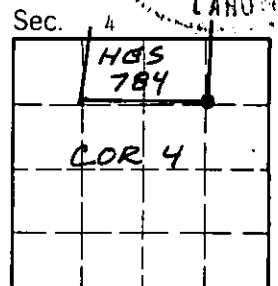

• - corner this sheet

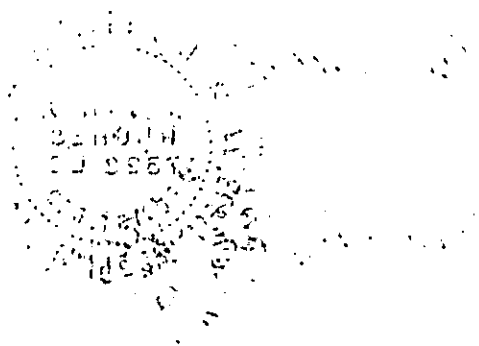

1950

1950